

MIXX 86

Digital Mixer
数字调音台



100% recycled paper
100% papier recyclé



www.relacart.com

使用说明书
Installation and Operation

Contents

Installation and Use of Software	2
Introduction	3
Product Introduction	3
Packing List	4
Product Introduction	5
Front panel	5
Applying Effects	9
Rear panel	11
Quick Start Guide	13
Quick Guide	23
1 CONNECTING SPEAKERS, MICROPHONES, INSTRUMENTS, ETC.	23
2 SPEAKER OR EARPHONES EMIT SOUND	23
Instructions for using control software	25
Control Page	26
Compressor Settings	27
Equalizer settings	28
Specification	29
Precautions	30

目录

软件安装及使用	33
引言	34
产品介绍	34
包装清单	35
产品面板介绍	36
MIXX8.6(调音台)前面板	36
应用效果器	39
MIXX8.6(调音台)后面板	41
快速入门指南	43
快速指南	53
1 连接音箱、话筒和乐器等	53
2 音箱或耳机放出声音	53
控制软件使用说明	55
控制界面	56
压缩器设置	57
均衡器设置	58
技术指标	59
注意事项	60

Installation and Use of Software

1 Operating System Requirements

Compatible system: Android / iOS / Windows

Software language: Chinese / English

2 Application software download

1. Software installation:



MI.AUDIO

2. When the software download is completed, connect the device to the USB interface of the smartphone or computer, and open the MI.AUDIO software to use it.

Note: Android requires permission to use external devices every time.

Introduction

Thank you for choosing RELACART Digital Mixer, and welcome you to join our team of tens of thousands of professional users. Our professional design and production experience ensure the excellent performance of our products in terms of quality, performance and stability.

Product Introduction

MIXX 8.6 digital mixer designed with 8 inputs and 6 outputs. Built-in digital audio processing functions, such as effector, EQ, compressor, etc. And it is equipped with a USB interface, which can transmit audio by mobile phones and computers. It has 16 types of digital reverb effects, which can be easily adjusted for various occasions with the encoder. MIXX8.6 has a simple and exquisite appearance, with reasonable layout of function buttons, suitable for various small-scale performances, conferences, speeches, KTVs, live streaming, and other occasions.

Functions include:

- The mixer panel can turn on and off various functions, including EQ, compressor, mute, reverb, 48V phantom power, etc.
- 1-4 input channels can select MIC or LINE input source. 3 and 4 input channels can be set as instrument input sources. And it can be set by button switches.
- 1-4 channels can provide +48V phantom power supply, which is controlled by panel button switches.
- USB output can be set in multiple audio modes to suitable for various applications.
- Professional reverb function, which can simulate various sound effects.
- When the audio is playing and listening, the MIX MINUS function can exclude the audio from 1-4 input channels.

Packing List



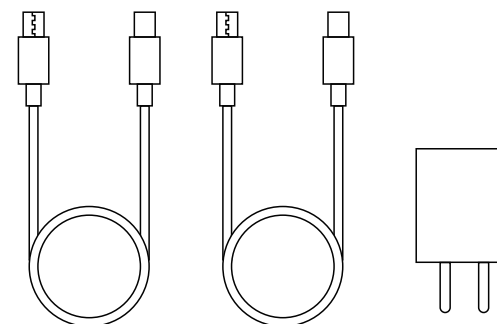



MIXX8.6 Mixer
 USB-C Power adapter
 TYPE-C to USB-A adapter *2
 Dual TYPE-C data cable *2
 Manual

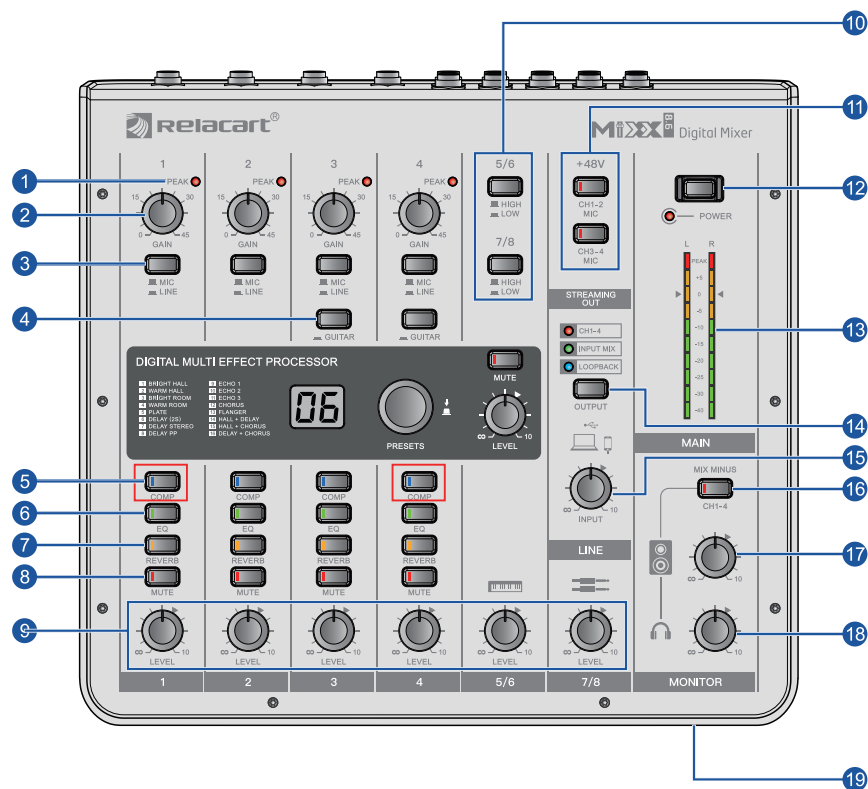

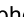
Product Introduction



MIXX8.6 (Digital Mixer) Front Panel

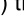

- 1 PEAK indicator light: When the audio signal input is overloaded, the red light will light up; If it lights up red, please adjust the "GAIN" knob 2 to the left to reduce the volume.
- 2 GAIN knob: It determines the basic volume of each channel from channel 1 to channel 4. Adjust these knobs to increase or decrease the current channel volume. The maximum gain is 45dB.
- 3 MIC/LINE button: Used to switch the () MIC microphone/ () LINE line input status on channels 1 to 4.
- 4 GUITAR button: Used to switch (open/close) the input impedance on each channel of channel 3 and channel 4. When the guitar, bass, etc. with high impedance output are directly connected to channels 3 and 4, this button needs to be turned on. When this button is turned on, it is necessary to connect the instrument to the mixer using an unbalanced cable with a phone type plug. If a balance line is used, the mixer will not work.
Note: When operating this button, turn all output controls (such as the [] Speakers knob 17 and [] Headphones knob 18 fully to minimum. Sudden high level peaks caused by the switching operation can damage external equipment as well as the hearing of those present.
- 5 COMP button: This button can open the compressors on channel 1 to channel 4 (highlighted in blue).
- 6 EQ button: This button can turn on the equalizer on channel 1 to channel 4 (green light on). This operation will automatically adjust to the optimal setting for online live streaming. This can adjust and compensate for defects in the speaker and sound field, and modify various input sound sources.
- 7 REVERB button: This button can turn on reverb on channel 1 to channel 4 (orange light on). This operation will turn on reverb by default, adding a natural sense of space to the sound.
- 8 MUTE button: This button can mute channels 1 to 4 (red light on).
- 9 LEVEL knob: Adjust the volume balance between each channel.
1-4 : Adjust the output volume of the sound input from the microphone or other sound sources connected to channels 1 to 4.
 : Adjust the output volume of the sound input from the electronic keyboard or other sound sources connected to channel 5/6.
 : Adjust the output volume of the sound input from the audio device or other sound sources connected to channel 7/8.
- 10 HIGH/LOW attenuation button: Used to switch (on/off) the attenuation input on channels 5/6 and 7/8. Turning on () this button will attenuate the sound input

* Restore factory setting: Long press the circled button in channel 1(shown above) and COMP button in channel 4 simultaneously for 10 sec can restore factory setting.

to this device.

Note: Before turning on () and off () the attenuation button, please adjust the "LEVEL" level knob to the minimum. Otherwise, noise may be generated when switching the switch.

- 11 +48V button: These buttons can turn on the phantom power supply on channels 1-2 and 3-4 (highlighted in red). When this button is turned on, DC+48V phantom power will be supplied to the XLR plug on the MIC input socket. When using a condenser microphone that requires phantom power supply, please turn on this switch button.

Notice





If phantom power is not required, please make sure to set this switch button to off (button indicator light goes off).

When turning on the +48V phantom power supply switch (with a red light on), in order to prevent noise and damage to the mixer and external equipment, please follow the following important precautions.

- When connecting devices that do not support phantom power supply on channel 1-2 and channel 3-4, ensure that this switch remains turned off (button indicator light is off).
- When connecting or disconnecting cables from channel 1-2 and channel 3-4, make sure to turn off this switch button (button indicator light is off).
- Before turning on/off this switch, please adjust the level knobs on channels 1-2 and channel 3-4 to "∞" (minimum).

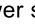
- 12 POWER switch: When the mixer is turned on, the LED indicator lights up (long press for 3 seconds to turn on or off the device).
- 13 MAIN level meters: These peak level meters are composed of two columns of 10 LEDs, with three colors representing signal levels in different ranges and a traffic light style. Their range ranges from -40dB (green) at the bottom, to 0dB in the middle, and then to PEAK (red) at the top.
- 14 STREAMING OUT button: Press this button in sequence to select the sound effect to be sent to the computer or smartphone. The LED indicator lights up to indicate the currently selected effect.
- CH1-4: Sends sound from the microphone/line jack from channel 1 to channel 4 to the computer or smartphone.
- INPUT MIX: Sends sound from the microphone/line jack of channel 1 to channel 4, BGM or sound effects of channels 5/6 and 7/8 to a computer or smartphone.

LOOPBACK: Mix the BGM or sound effects from the microphone/line jack on channel 1 to channel 4, channels 5/6, and 7/8, with the BGM or other audio input from the computer or smartphone, and send them to the computer or smartphone.

- 15 INPUT knob: Adjusts the volume of input from your computer or smartphone.
- 16 MIX MINUS button: When this switch button is turned on, the sound input from channel 1 to channel 4 will not be output from STEREO jack 31, MONITOR jack 30, PHONES output jack 28, and main headphone [] output jack 19.
- 17 Speaker knob: It can adjust the volume of the device connected to the monitoring MONITOR socket 30.
- 18 Headphone knob: Adjust the volume of the headphones connected to the PHONES output jack 28 and [] main headphone output jack 19.
- Note: The speaker [] knob and the earphone [] knob can be adjusted separately.
- 19 Main headphone [] output jack: used to connect your headphone jack.

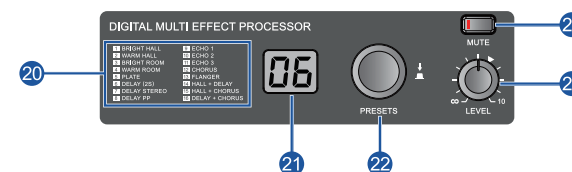

- 20 Effect Program List: This list is a list of internal preset effect programs. For details on the parameters, please refer to the "Effect Program" list on the following table.
- 21 Display screen: It can display the preset effect program number selected by the current PRESETS knob 22, and the number will flash during the selection process.
- 22 PRESETS knob: You can choose from one of 16 internal preset effects. Turn this knob to select the effect program you need, and then press the knob to confirm the setting; If there is no operation selection within a few seconds, the program will return to the last selected number. For instructions on how to apply effects, please refer to the "Applying Effects" section below.
- 23 MUTE preset mute button: When this switch button is turned on, the internal preset effect processor will mute and its output will not appear in the main or monitor mix. The button indicator light will light up to indicate that the effect has been muted.
- 24 LEVEL preset level knob: Adjusts the volume of the internal preset effect input sound.

Applying Effects

The MIXX8.6 comes with a high-quality internal signal processing effector, which is as advanced in technology as our famous Podcast+ effector. The applying effects (as described below) allows you to simulate sound effects in different playing environments.

1. Turn the PRESETS knob and select the effect program number from the effect program list.

The currently selected effect program number flashes in the display screen.

Note: For details on the effect program, please refer to the “Effect Program” list on the next page.

2. Press the PRESETS knob to select.

Select the effect program.

3. Press the MUTE mute switch button (red light on), and the application effect will be muted.

4. Turn the LEVEL knob to adjust the volume of the application effect.

Effect Program

No.	Program	Parameter	Description
1	BRIGHT HALL	DECAY TIME	Simulate bright large spaces such as concert halls.
2	WARM HALL	DECAY TIME	Simulate warm large spaces such as concert halls.
3	BRIGHT ROOM	DECAY TIME	Simulate the brightness of the acoustic environment in small spaces (rooms).
4	WARM ROOM	DECAY TIME	Simulate the gentle acoustic environment of small spaces (rooms).
5	PLATE	DECAY TIME	Simulate metal effect units and produce more sharp edges and corners.
6	DELAY (2S)	DECAY TIME	Add a feedback delay for multiple 2-second signals.
7	DELAY STEREO	DECAY TIME	Add feedback delay for multiple stereo delay signals.
8	DELAY PP	DECAY TIME	Added feedback delay for multiple ping-pong effect delay signals.
9	ECHO 1	DECAY TIME	Use different ordinary echoes.
10	ECHO 2	DECAY TIME	
11	ECHO 3	DECAY TIME	
12	CHORUS	SPEED	Delay time adds multiple layers of sound, creating a heavy sense of ensemble sound.
13	FLANGER	SPEED	Add debugging sounds to the sound, producing a popping sound similar to a jet engine.
14	HALL+DELAY	DECAY TIME	Add feedback delays for multiple large-space delay signals.
15	HALL+CHORUS	SPEED	Add multiple layers of sound to a large space, creating a thick and heavy sense of ensemble sound.
16	DELAY+CHORUS	SPEED	Delay time adds multiple layers of sound, creating a thick and heavy sense of ensemble sound.

MIXX8.6 (Digital Mixer) Rear Panel

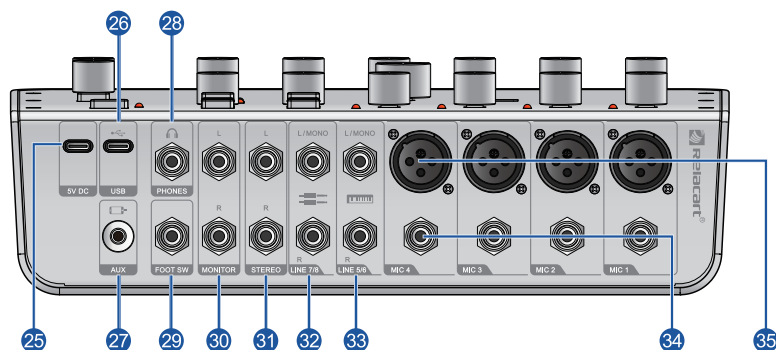

- 25 5V DC port: used to connect to commercially available USB power adapters or USB mobile power supplies. This port can be used when the mixer is connected to a tablet computer or other device that cannot power the mixer.

Notice

- Before using this product, please be sure to read the safety precautions for the USB power adapter or USB mobile power supply you are using.
- Please use a USB mobile power supply or USB power adapter with an output voltage of 4.8V to 5.2V and an output current of at least 1A or higher.

- 26 USB port: Use the included USB-C cable to connect to the computer. When connected to a computer, the computer supplies power to the audio mixer, and audio data can also be transmitted between the audio mixer and the computer.

Notice

Please do not connect other devices to the USB port except for PC, tablet or smartphones.

- 27 AUX input jack: This is an auxiliary input jack that supports stereo mini jack. You can connect to a smartphone or other device and use the application to trigger sound effects or background music. Adjust the volume by using the connected external audio device controller.

- 28 PHONES output jack: Used to connect headphones, this jack supports stereo phone type plugs.

- 29 FOOT SW jack: Supports phone type plug for connecting pedal switches. When applying the preset effect of EFFECT, it can be muted.

- 30 MONITOR output jack: Supports phone type plug (unbalanced) for connecting to active monitor speakers.

- 31 STEREO output jack: Supports a phone type plug for connecting to other mixing consoles or recorders, and outputting mixed sound in stereo. The sound output from this socket will not be affected by the [OUTPUT] switch button 14 of STREAMING OUT or the speaker [] knob 17.

- 32 LINE 7/8 Input jack: Supports phone type plugs for connecting line signal devices, such as audio devices. Use the "L/MONO" jack of channel 7/8 to connect instruments with mono output, etc. In this case, the input to the "L/MONO" jack is output from both the left and right channels of the mixer.

- 33 LINE5/6 Input jack: Support phone type plug, used to connect line signal equipment, such as electronic keyboards, etc. Use the "L/MONO" jack of channel 5/6 to connect instruments with mono output, etc. In this case, the sound input to the "L/MONO" jack will be output from both left and right channels of the audio mixer simultaneously.

- 34 MIC1/4 jack: These 1/4" sockets share the circuit with the microphone preamplifier (does not support phantom power supply) and can be driven by balanced or unbalanced sources of any electrical level. You can use these inputs to process any signal you encounter.

- 35 MIC XLR jack: This is a XLR female connector(support phantom power supply), it can accept balanced microphone or line electrical level inputs from any type of source. These professional dynamic and condenser microphone preamplifiers have a higher fidelity, comparable to any independent microphone preamplifier on the market. These circuits are excellent in eliminating buzzing and noise.

Quick Start Guide

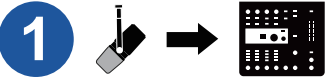

Connect to your microphone

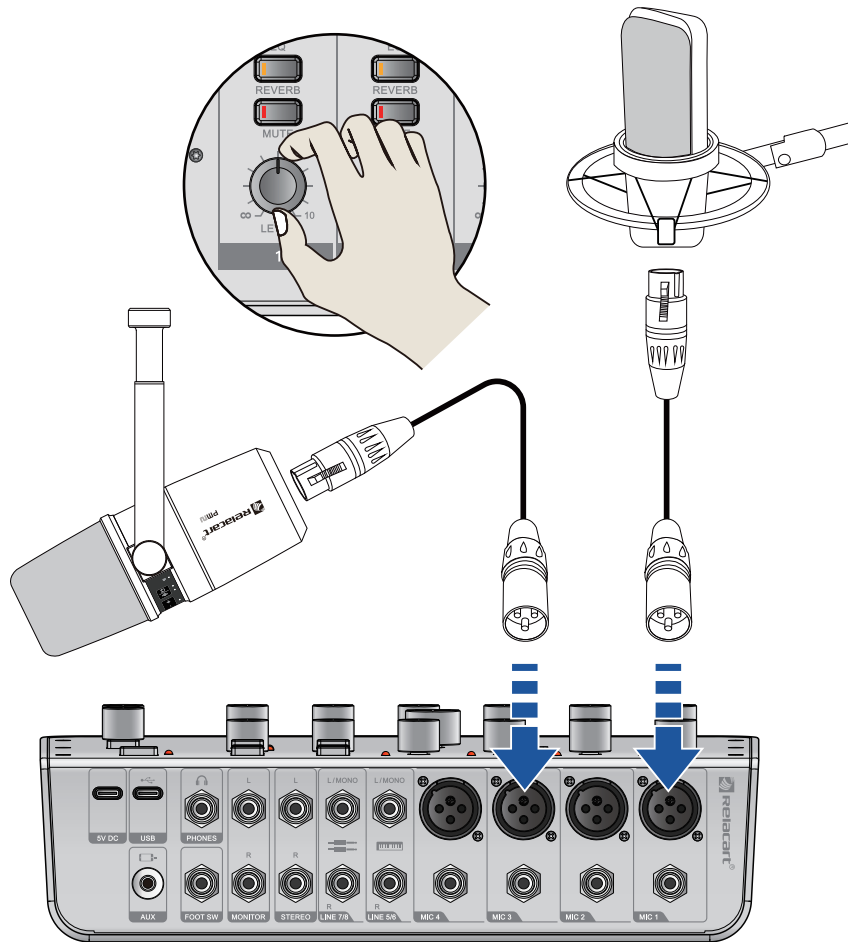

Connect to your musical instrument

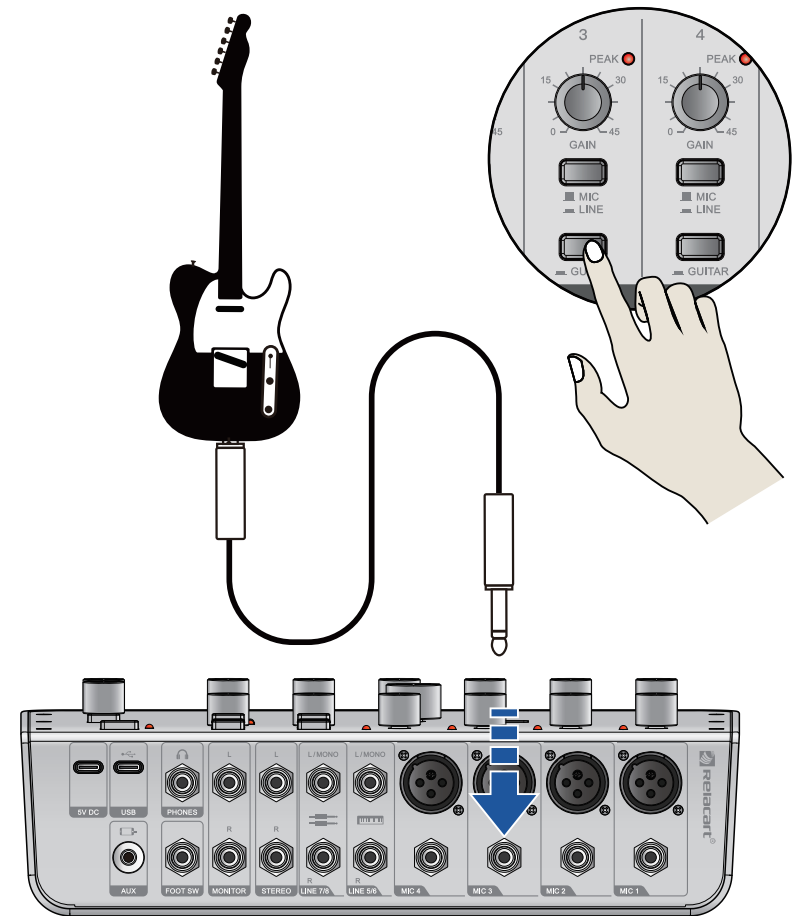



Connect to your electronic keyboard device

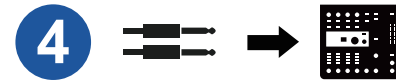
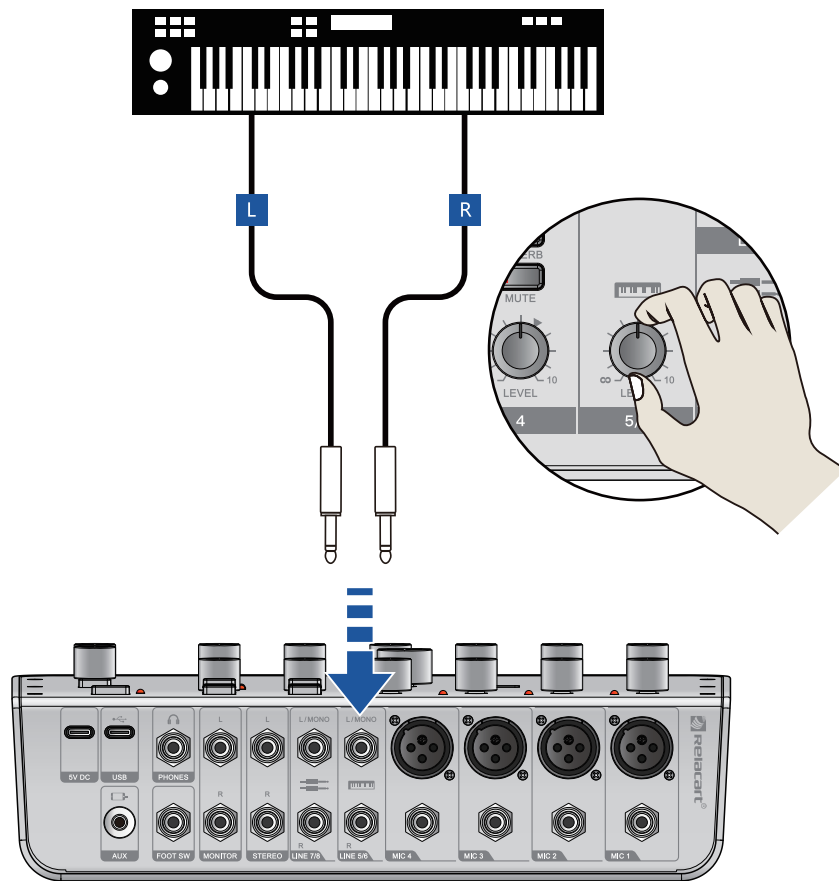

Connect to your line input device

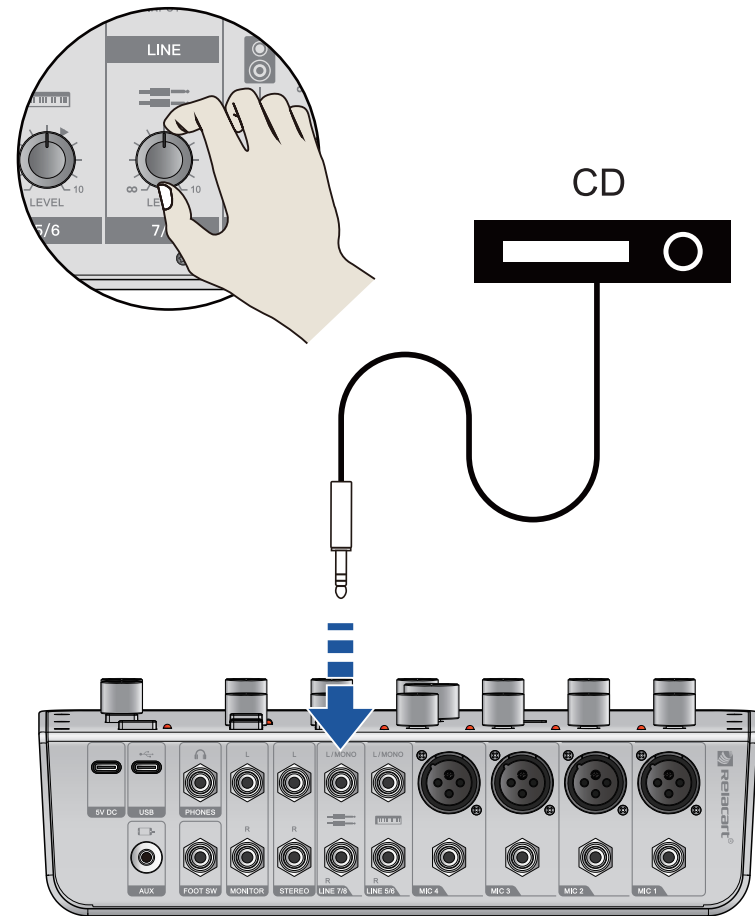



Connect to your active speaker

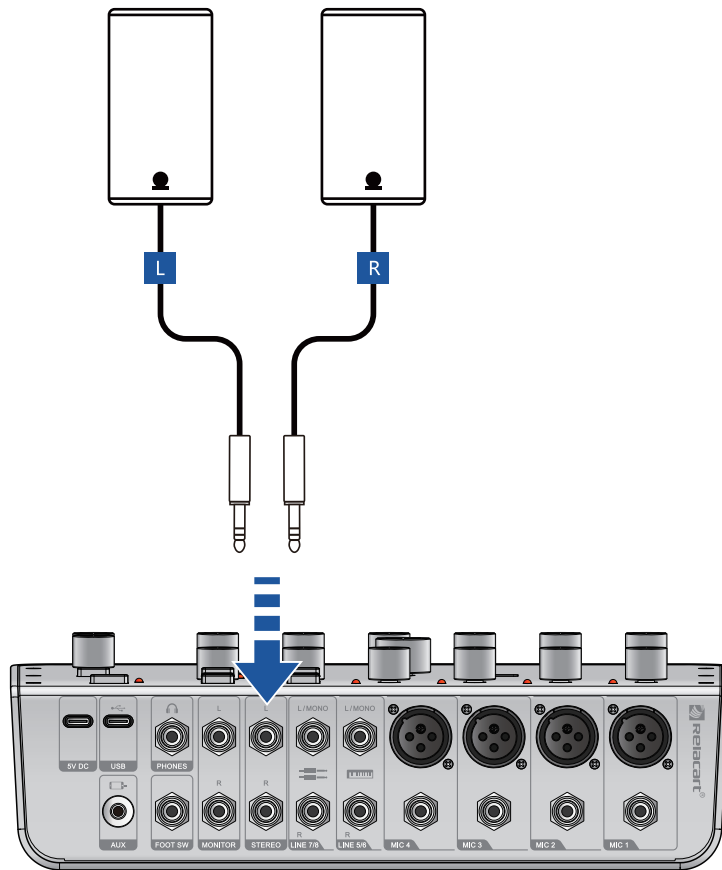

Connect to your active monitor speaker

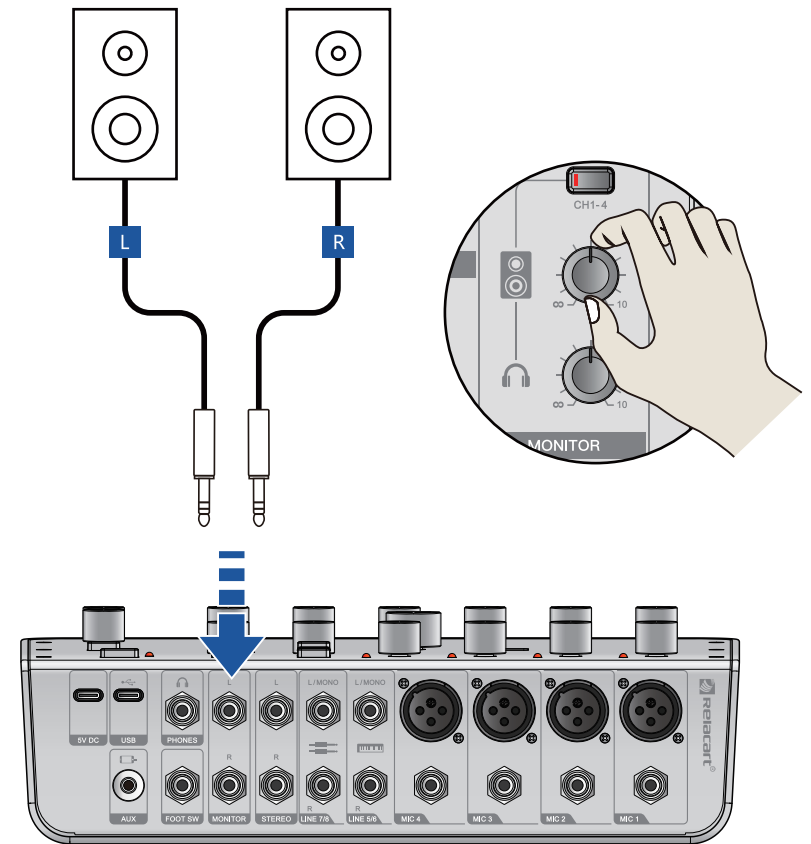



Connect to your Headphone

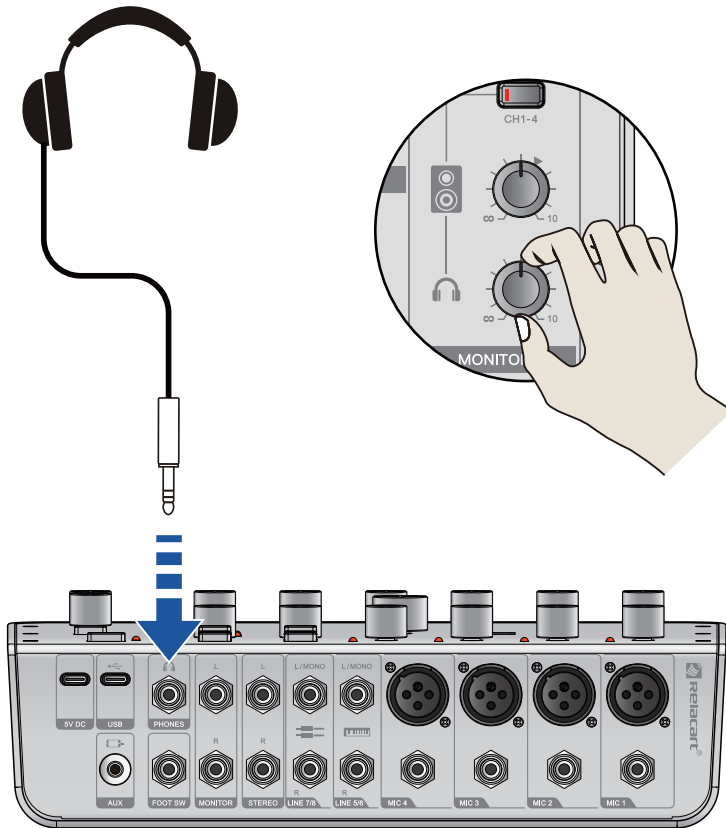

Connect to your pedal switch

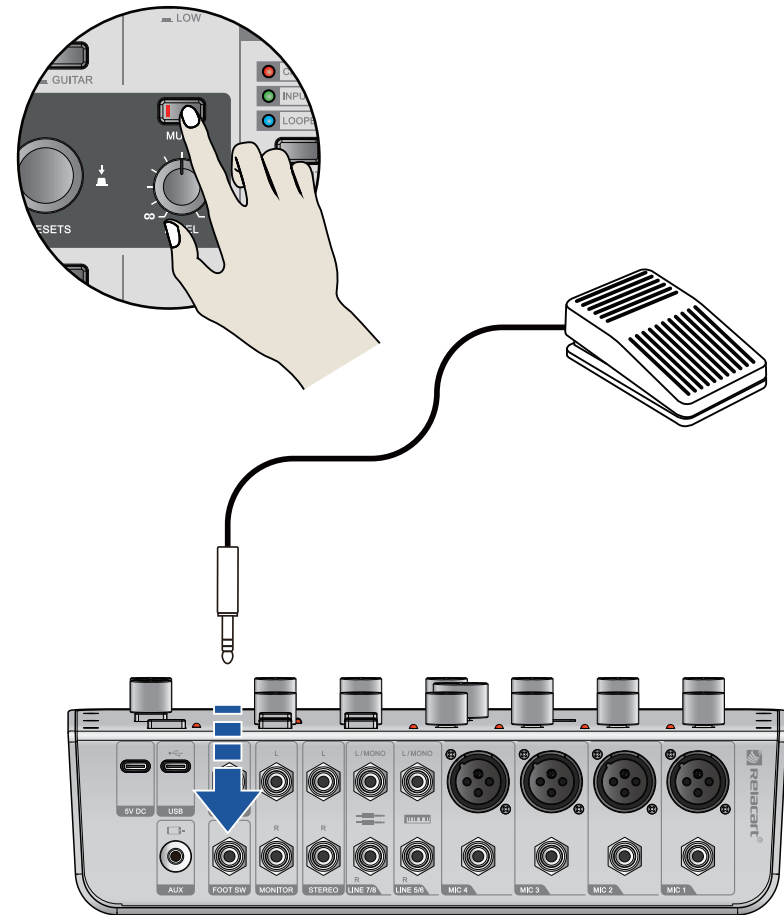



Connect to your mobile phone through an audio cable

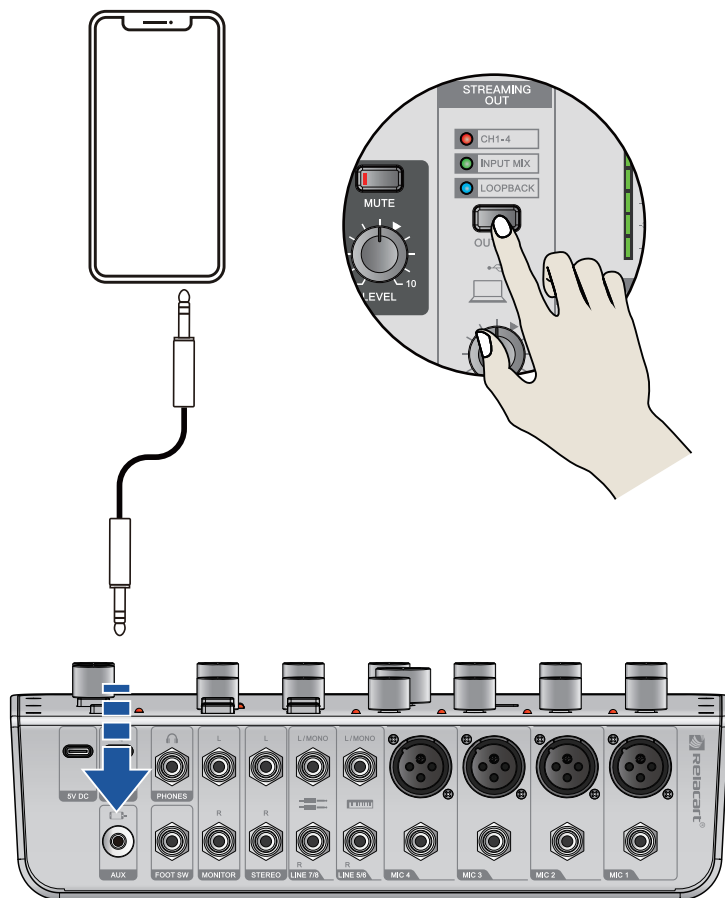

Connect to your computer or smartphone through a data cable

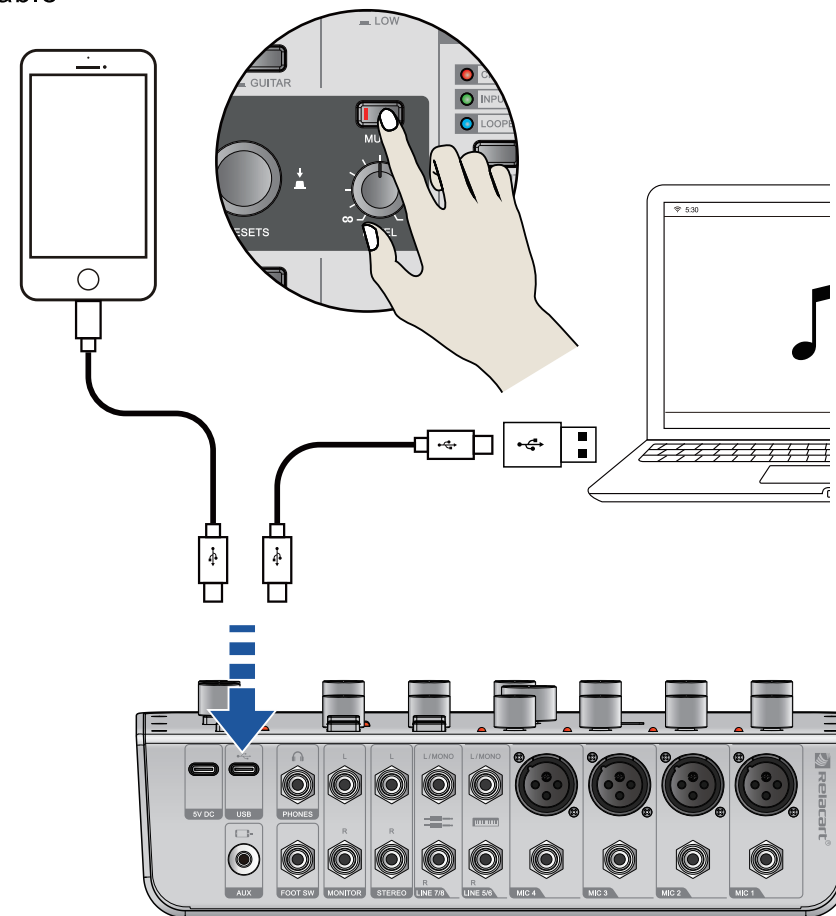

Quick Guide

1 CONNECTING SPEAKERS, MICROPHONES, INSTRUMENTS, ETC.

1. Turn off the power of all speakers, instruments, and other external devices connected to the audio mixer.
2. Refer to the connection example to connect speakers, microphones, and instruments.

2 SPEAKER OR EARPHONES EMIT SOUND

1. Ensure that all switch buttons, including the POWER switch, are not pressed.
2. Connect the mixer to the computer by using the USB cable that attached to the product.
When using the USB jack on the rear panel of the mixer, please refer to the "Precautions for using USB and 5V DC sockets". When connecting a tablet computer or other device that cannot power the mixer, please connect a commercially available USB power adapter or USB mobile power supply to a 5V DC jack (USB-C).
3. Fully adjust the GAIN knob, LEVEL knob, speaker [] knob, and headphone [] knob to the left (minimum).

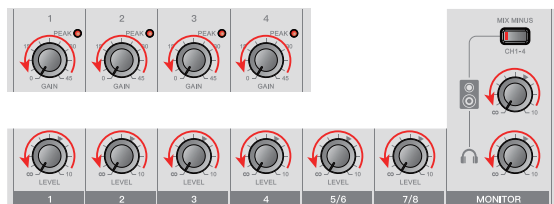

4. Ensure that the volume of the active speaker is set to the minimum.
5. Turn on the power of the connected devices in the following order: instrument — audio device — mixer power — active monitoring speaker.
Note: Following this sequence of operations can prevent the speaker to produce huge unexpected noise. When turning off the power, simply reverse the this sequence.
6. For channels that have already connected microphones or instruments, the GAIN knob can be set to approximately 12 o'clock position.

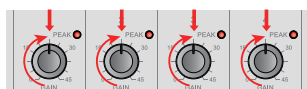

7. Adjust the LEVEL knob to the 3 o'clock position.

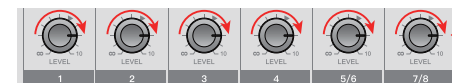

8. Adjust the speaker knob [] and earphone knob [] to the 12 o'clock position.

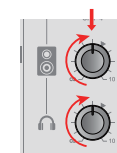

9. Speak into the microphone for sound test, play an instrument or play an external audio device, and then adjust the volume of the active speaker.
10. If you cannot hear sound or want to adjust the volume, please follow the instructions below.

No sound or need to increase the volume

1. Speak or play an instrument to the microphone, adjust the GAIN knob to the right to briefly flash the corresponding PEAK LED light.
Note: • To achieve the best volume when using a microphone, please place the microphone as close to the sound source as possible.
• If the GAIN knob has been fully adjusted to the far right and the PEAK LED still cannot light up, the volume of the sound source (instrument, etc.) can be increased.
- If after performing step 1, there is still no sound or the volume cannot be increased:
2. If the [MIC/LINE] switch button or the [HIGH/LOW] switch button has already been turned on (), please fully adjust the LEVEL level knob to "∞" (minimum), and then turn off () this switch button.
 3. Slowly turn the LEVEL level knob to the right until the desired sound volume is reached.

To lower the volume

1. Fully adjust the LEVEL level knob to "∞" (minimum), then turn on () the [MIC/LINE] switch button or the [HIGH/LOW] switch button on the channel where the volume is to be lowered.
2. Slowly turn the LEVEL knob to the right until the desired volume is reached.
If the volume cannot be lowered after the above steps are performed:
3. Reduce the volume of external or audio devices.

Instructions for using control software

After the MI.AUDIO software is downloaded and installed, please connect the MIXX8.6 mixer to the USB interface of your smartphone or computer, open the MI.AUDIO software, select the MIXX8.6, and then enter the control page.



- 1 Home page
Click on the three point areas to access application settings, version information, and user guides.
- 2 Equipment selection
Slide left and right to select the product device.
- 3 Learn more buttons
After selected the device, press this button to enter the product understanding.
- 4 Start button
Press this button to enter the product settings interface. If the device is already connected, automatically read the device settings; If the device is not connected, it will display offline status.

Control Page

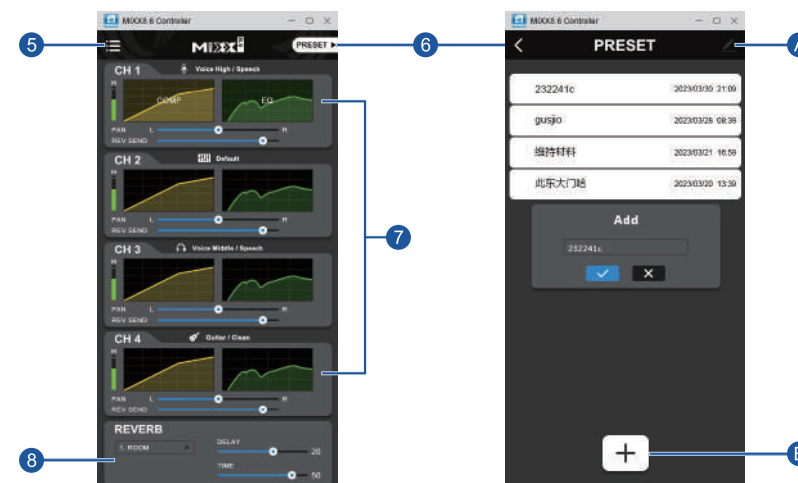

- 5 Home page
Click on the to access application settings, version information, and user guides.
- 6 Mixer preset settings
Press this button to enter the product preset page, where you can click B to add or A to delete the set parameters and save them to the preset settings. Up to 10 settings can be saved, with presets only retained on the currently used device.
- 7 Channel Status
Display the setting effect status of four channels, click on the COMP/EQ chart of each channel to enter the settings separately. You can also freely adjust the volume of left and right audio and auxiliary transmission.
- 8 Reverb Settings
Click on the drop-down menu to select a simulation effect, and there are a total of 12 effects. Reverberation is a type of effect that simulates the feeling of a performance space from a hall to a small room by adding signals, resulting in the depth and width of the sound.
 - ◆ DELAY: Adjust the time required for the sound to return to the ear after reflection, with an adjustable range of 1 ~ 100.
 - ◆ TIME: Adjust the duration of the reverberation effect, with an adjustable range of 1 to 100.

Compressor Settings

Compressor is a kind of amplifier with the input signal level increase and its own gain reduction.

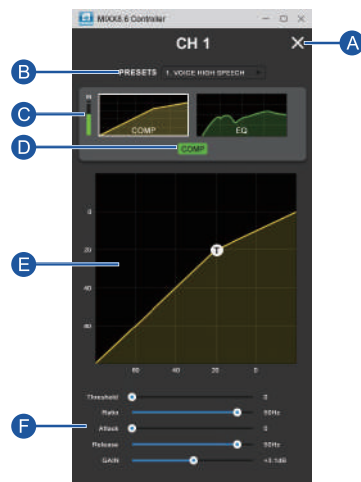

- A** COMP Page close button
After adjusting the COMP parameters, click to close the COMP page. (There is no need to save additional parameters. The mixer automatically saves the parameters for each step of operation.)
- B** Preset selection
Click and drop down menu to select default preset Settings.
- C** Level indication
Display the level value of the current channel input.
- D** COMP button
Grey indicates the COMP effect is turned off; Green indicates the COMP effect is turned on.
- E** COMP Adjusting Window
You can drag any COMP frequency point within the COMP function window to achieve the appropriate effect.
- F** COMP Settings
Corresponding to the threshold of the COMP adjustment window, you can also drag the pusher to fine tune the parameters of the threshold.
 - ◆ Threshold: Adjust the threshold (and critical level) of the compressor, with an adjustable range of 0dB ~ -60dB.
 - ◆ Ratio: The compression ratio is 1:250, and the higher the compression ratio, the smaller the compression amplitude; The smaller the compression ratio, the greater the compression amplitude.
 - ◆ Attack: The time required for the compressor to open after the input signal exceeds the threshold, adjustable range: 1~128ms.
 - ◆ Release: The time required for the compressor to close after the input signal is less than the threshold, with an adjustable range of 100ms to 4000ms.
 - ◆ GAIN: Adjust the level gain of the compressor, with an adjustable range of 0dB ~ -120dB.

Equalizer settings

Equalizer can adjust the effect of tone by enhancing and attenuating specific frequencies.

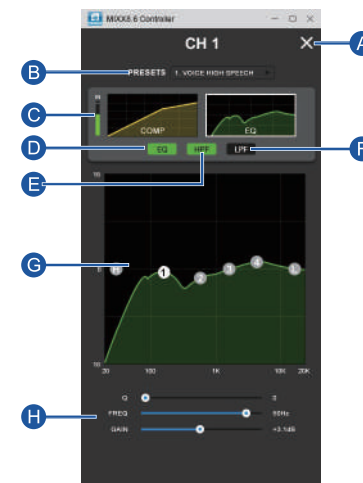

- A** EQ Page close button
After adjusting EQ parameters, click to close the EQ Page. (There is no need to save additional parameters. The mixer automatically saves the parameters for each step of operation.)
- B** Preset selection
Click on the drop-down menu to select preset settings.
- C** Level indication
Display the level value of the current mixer input.
- D** EQ button
Grey indicates the effect of turning off EQ; Green indicates turning on the EQ effect.
- E** HPF button
Grey indicates the HPF effect is turned off ; Green indicates the HPF effect is turned on. Used to cut off unwanted low sound and for applications such as cutting.
- F** LPF button
Grey indicates the LPF effect of is closed ; Green indicates the LPF effect is turned on. Used to cut off unwanted high sound and for applications such as cutting.
- G** EQ adjustment window
You can drag EQ frequency points freely within the EQ function window to achieve appropriate results. There are a total of 4 frequency points that can be set.
- H** EQ frequency point setting
Corresponding to the EQ adjustment window's frequency band , you can also drag the pusher to adjust the parameters of the frequency band .
 - ◆ Q (Q value): Adjust the slope of the audio curve, adjustable range: 0.1-20.
 - ◆ FREQ (frequency): Adjustable range: 20Hz~20KHz.
 - ◆ GAIN: Adjust the level gain of the equalizer, with an adjustable range of +18dB~-18dB.

Specification

Sample Rate:	24-bit, 48KHz
Frequency Respond:	20Hz to 20KHz +0/-1dB
T.H.D.:	<0.1%
Signal to Noise Ratio:	90dB Single channel max fader (A weighted)
Dynamic Range:	100dB Single channel max fader (A weighted)
Common Mode Rejection Ratio:	>70dB @ 1KHz
MIC Input Impedance:	3.3KΩ (XLR Balance); 1.8KΩ (1/4")
LINE Input Impedance:	10KΩ (1/4")
Output Impedance:	150Ω
Gain:	0 to 45dB (XLR)
FOOT SW :	REVERB ON/OFF
Phantom Power Supply:	+48V
USB Audio:	2 IN/2 OUT compliant with USB audio class 2.0
Power Supply:	DC 5V (1A)
Power Consumption:	Up to 5W
Dimensions (mm):	260 (L) x 230 (H) x 89 (D)
Weight:	≈ 1.45 Kg

PRECAUTIONS

Please read carefully before proceeding
Please keep this manual in a safe place for future refer - ence.

WARNING

Always follow the basic precautions listed below to avoid the possibility of serious injury or even death from electrical shock, short-circuiting, damages, fire or other hazards. These precautions include, but are not limited to, the following:

Power supply/Power cord

- Only use the voltage specified as correct for the device. The required voltage is printed on the name plate of the device.
- Use only the power cord provided.
- Do not place the power cord near heat sources such as heaters or radiators, and do not excessively bend or otherwise damage the cord, place heavy objects on it, or place it in a position where anyone could walk on, trip over or roll anything over it.
- Please be sure to connect to an appropriate power outlet with a protective grounding connection. Improper grounding may cause electric shock.

Do not open

- Do not open the device or attempt to disassemble the internal parts or modify them in any way. This device contains no user - serviceable parts. If it should appear to be malfunctioning, discontinue use immediately.

Warning about humidity

- Do not expose the device to rain, use it near water or in damp or wet conditions, or place on it any containers (such as vases, bottles or glasses) containing liquids which might spill into any openings.
- Never insert or remove an electric plug with wet hands.

If you notice any abnormality

- If the power cord is frayed or damaged, there is a sudden loss of sound during use of the device or it emits unusual smells or smoke, please turn off the power switch immediately.
- If this device should be dropped or damaged, immediately turn the power off, disconnect the electric plug from the outlet.

CAUTION

Always follow the basic precautions listed below to avoid the possibility of physical injury to you or others, or damage to the device or other property. These precautions include, but are not limited to, the following:

Power supply/Power cord

- Remove the electric plug from the outlet when the device is not to be used for extended periods of time, or during electrical storms.
- When removing the electric plug from the device or an outlet, always hold the plug itself and not the cord. Pulling by the cord can damage it.

Placement location

- Before moving the device, remove all connected cables.
- When setting up the device, make sure that the AC outlet you are using is easily accessible. If some trouble or malfunction occurs, immediately turn the power off and disconnect the plug from the outlet.
- If the device is installed in EIA standard brackets, keep the back of the brackets open and keep the device at least 10cm away from a wall or surface. In addition, if the equipment is installed together with power amplifiers and other equipment that generally generate heat, please make sure that there is enough space between the equipment and the equipment that generates heat, or install ventilation panels to place the equipment inside to achieve high temperature.
- Poor ventilation can lead to overheating and can damage equipment or even cause a fire.
- Avoid setting all equalizer and level knobs to their maximum. Depending on the condition of the connected devices, doing so may cause feedback and may damage the speakers.
- Do not expose the device to excessive dust or vibration, or extreme cold or heat (such as in direct sunlight, near a heater, or in a car during the day), in order to prevent the possibility of panel disfiguration or damage to the internal components.
- Do not place the device in an unstable position where it might accidentally fall over.
- Do not block the ventilation holes. This device has ventilation holes on the front and back to prevent excessive temperature inside the device. Be especially careful not to place the device on its side or upside down. Poor ventilation can cause overheating and can damage equipment settings and cause fires.

Connections

- Before connecting the device to other devices, turn off the power for all devices. Before turning the power on or off for all devices, set all volume levels to minimum.
- When connecting the speaker to the speaker jack, use the speaker cable. Using other kinds of cables can cause fires.

Handling caution

- Do not use the device in the vicinity of a TV, radio, stereo equipment, mobile phone, or other electric devices. Otherwise, the device, TV, or radio may generate noise.
- When turning on the AC power in your audio system, always turn on the device FIRST, to avoid speaker damage. When turning the power off, the device should be turned off FIRST for the same reason.
- Do not insert fingers or hands into any gaps or openings (vents, etc.) of the device.
- Avoid inserting or dropping foreign objects (paper, plastic, metal, etc.) into any gaps or openings (vents, etc.) on the device. If this happens, turn off the power immediately and unplug the power cord from the DC/AC outlet.
- Do not use speakers or headphones for a long period of time at a high or uncomfortable volume level, since this can cause permanent hearing loss. If you experience any hearing loss or ringing in the ears, consult a physician.
- Do not rest your weight on the device or place heavy objects on it, and avoid use excessive force on the buttons, switches or connectors.
- When cleaning the device, use a dry and soft cloth. Do not use paint thinners, solvents, cleaning fluids, or chemical - impregnated wiping cloths.

软件安装及使用

1 操作系统要求

兼容系统: Android/iOS/Windows

软件语言: 简体中文/英文

2 应用程序软件下载

1、软件安装:



MI.AUDIO

2、当软件下载完成, 将设备连接至智能手机或电脑的 USB 接口, 并且打开 MI.AUDIO 软件, 即可使用。

注意: Android 每次都需要获得许可才能使用外部设备。

引言

感谢您选用 RELACART 力卡数字调音台, 并欢迎您加入我们数以万计的专业用户队伍。我们的专业设计和生产经验确保了我们的产品质量, 性能及稳定性等各方面的优良表现。

产品介绍

MIXX8.6 数字调音台, 设计8路输入6路输出。内置效果器、均衡器、压缩器等数字音频处理功能。并配置 USB 接口, 可使用手机、电脑传输音频。内置 16 种数字混响效果, 配合编码器轻松调节各种场合的音效。外观设计高端大方, 功能按键布局合理, 适用于各种小型演出、会议、演讲、家庭 KTV、娱乐直播等场合。

功能包括:

- 调音台面板可以开关各项功能, 包括 EQ、静音、压缩器、混响、48V 幻象电源等。
- 输入通道 1-4 可以选择 MIC 或 LINE 输入源。其中输入通道 3 和 4 可以设为乐器输入源, 通过按钮开关进行设置。
- 通道 1-4 可提供 +48V 幻象供电, 通过面板按钮开关控制。
- USB 输出可设置多种音频模式, 以适应各种应用场合。
- 专业的混响功能, 可以模仿多种声场效果。
- MIX MINUS 将输入通道 1-4 的音频排除在本地播放及监听。

包装清单

MiXX8.6 调音台
USB-C 电源适配器
TYPE-C 转 USB-A 转换头 *2
双头 TYPE-C 数据线 *2
说明书
合格证
保修卡

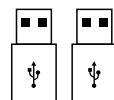
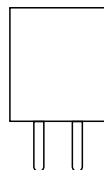
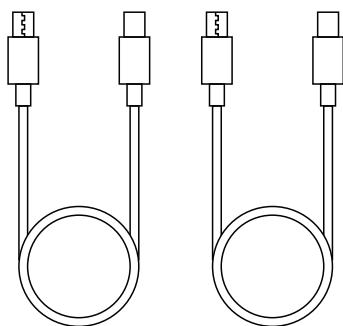

合格证

保修卡

产品面板介绍

MiXX8.6 (调音台) 前面板

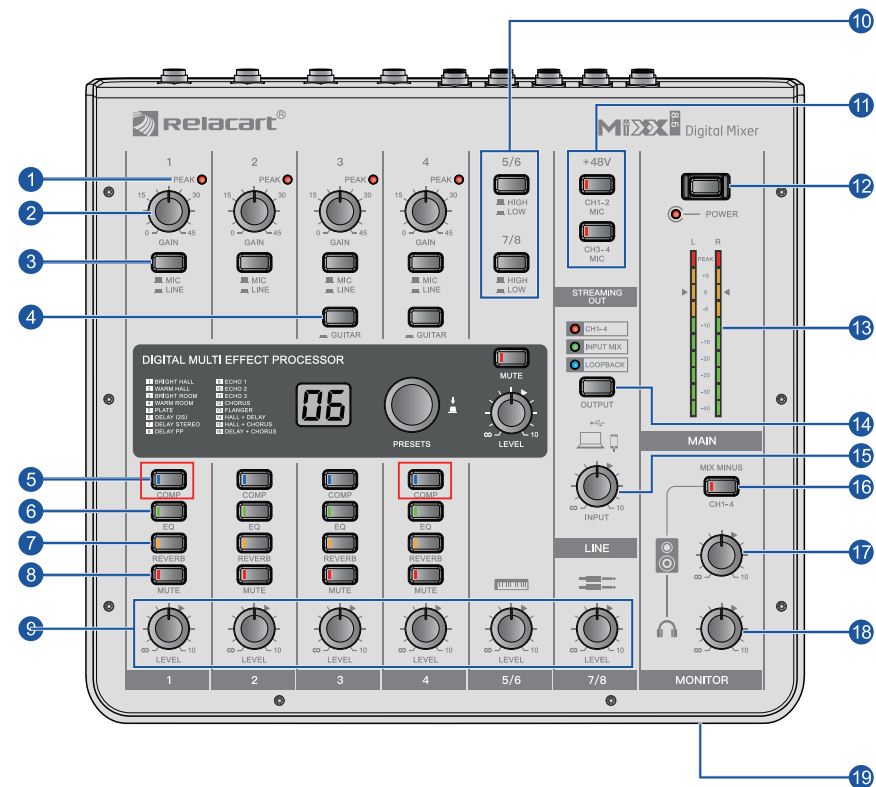

* 恢复出厂设置：同时长按上图的红色方框通道1和通道4的 COMP 键 10 秒，即可恢复出厂预设参数。

- ① PEAK 峰值指示灯：当音频信号输入过载时亮红灯；如果它亮起红色，请将“GAIN”旋钮 ② 向左调节，降低音量。
- ② GAIN 增益旋钮：决定通道 1 至通道 4 各通道的基本音量。调节这些旋钮，用于提升或衰减当前通道音量大小，最大增益为 45dB。
- ③ MIC/LINE 按钮：用于切换通道 1 至通道 4 各通道上的 (MIC) MIC 麦克风/ (LINE) LINE 线路输入状态。
- ④ GUITAR 按钮：用于切换（打开/关闭）通道 3 和通道 4 各通道上的输入阻抗。将高阻输出的吉他、贝司等直接连接到通道 3 和通道 4 时，要打开此按钮。当此按钮打开时，要用带有 phone 型插头的非平衡线将乐器连接到调音台。如果使用了平衡线，调音台将无法正常工作。
注：当操作此按钮时，请将所有输出控制器（如 [] 音箱旋钮 ⑪ 和 [] 耳机旋钮 ⑫）完全调节到切换操作所造成的瞬间峰值电平可能会损坏外接设备和旁观者的听力。
- ⑤ COMP 按钮：这些按钮可以打开通道 1 至通道 4 上的压缩器（蓝色亮起）。
- ⑥ EQ 按钮：这些按钮可以打开通道 1 至通道 4 上的均衡器（绿色亮起）。此操作会默认调整为适合网络直播的最佳设置。这样可以调节补偿扬声器和声场的缺陷，补偿和修饰各种输入音源。
- ⑦ REVERB 按钮：这些按钮可以打开通道 1 至通道 4 上的混响（橙色亮起）。此操作会默认打开混响，为声音添加自然的空间感。
- ⑧ MUTE 按钮：这些按钮可以将通道 1 至通道 4 设置为静音（红色亮起）。
- ⑨ LEVEL 电平旋钮：调节各通道间的音量平衡。
1-4：调节从麦克风或连接至通道 1 至通道 4 各通道上的其他声源所输入声音的输出音量。
⑨：调节从电子键盘或连接至通道 5/6 上的其他声源所输入声音的输出音量。
⑩：调节从音频设备或连接至通道 7/8 上的其他声源所输入声音的输出音量。
- ⑩ HIGH/LOW 衰减按钮：用于切换（打开/关闭）通道 5/6 和 通道 7/8 各通道上的衰减输入。打开 (H) 此按钮会衰减输入到本设备的声音。
注：打开 (H) 和关闭 (L) 衰减按钮之前，请先将“LEVEL”电平旋钮调节到最小。否则在切换开关时可能会产生噪声。
- ⑪ +48V 按钮：这些按钮可以打开通道 1-2 和 通道 3-4 上的幻象供电（红色亮起），此按钮打开时，DC +48V 幻象供电会供应给 MIC 输入插口上的 XLR 插头。使用需要幻象供电的电容话筒时，请打开此开关按钮。

须知

如果不需要幻象供电，请务必将此开关按钮设定为关闭（按钮指示灯熄灭）。

打开 +48V 幻象供电开关时（红色亮起），为防止产生噪声以及调音台和外接设备的损坏，请遵守下列重要注意事项。

- 在通道 1-2 和通道 3-4 上连接不支持幻象供电的设备时，确保此开关保持关闭状态（按钮指示灯熄灭）。
 - 从通道 1-2 和通道 3-4 上连接或断开线缆时，确保关闭此开关按钮（按钮指示灯熄灭）。
 - 打开/关闭此开关之前，请将通道 1-2 和通道 3-4 上的电平旋钮调节到“∞”（最小）。
- ⑫ POWER 电源开关：当调音台启动时，LED 指示灯亮起（长按3秒开启或关闭设备）。
 - ⑬ MAIN 电平表：这些峰值电平表由两列 10 个 LED 组成，有三种颜色表示不同范围的信号电平，红绿灯样式。它们的范围从底部的 -40dB（绿色），到中间的 0dB，再到顶部的 PEAK（红色）。
 - ⑭ STREAMING OUT 按钮：依次按下此按钮可选择发送到计算机或智能手机的声音效果，LED 指示灯亮起，表示当前选中的效果。
CH1-4：将来自通道 1 至通道 4 的麦克风/线路插孔的声音发送到计算机或智能手机。
INPUT MIX：将来自通道 1 至通道 4 的麦克风/线路插孔和通道 5/6，通道 7/8 的 BGM 或音效发送到计算机或智能手机。
LOOPBACK：将来自通道 1 至通道 4 的麦克风/线路插孔和通道 5/6，通道 7/8 的 BGM 或音效，从计算机或智能手机输入的 BGM 或其它音频混合后发送到计算机或智能手机。
 - ⑮ INPUT 旋钮：可以调节来自计算机或智能手机的输入音量。
 - ⑯ MIX MINUS 按钮：当此开关按钮打开时，从通道 1 至通道 4 输入的声音将不会从立体声 STEREO 插口 ⑰、监听 MONITOR 插口 ⑱、耳机 PHONES 输出插口 ⑲ 和主耳机 [] 输出插口 ⑲ 输出。
 - ⑰ 音箱旋钮：可以调节发送到连接在监听 MONITOR 插口 ⑱ 上的设备音量。
 - ⑱ 耳机旋钮：调节连接在耳机 PHONES 输出插口 ⑲ 和 [] 主耳机输出插口 ⑲ 的耳机音量。
注：音箱 [] 旋钮和耳机 [] 旋钮可以分别单独调节。
 - ⑲ 主耳机 [] 输出插口：用于连接您的耳机插头。

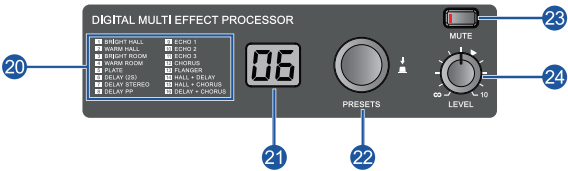

- 20 效果程序列表：此列表为内部预设效果程序的列表。有关参数的详情，请参考下列表格上的“效果程序”列表。
- 21 显示屏：可显示当前 PRESETS 旋钮 22 选定的预设效果程序编号，编号会在选择过程中闪烁。
- 22 PRESETS 旋钮：可从 16 种内部预设效果中选择一种。转动此旋钮选择需要的效果程序，然后按下旋钮确认设置；如果几秒钟内没任何操作选择，程序将返回最后一次选定的编号。有关如何应用效果的说明，请参考下列的“应用效果器”章节。
- 23 MUTE 预设静音按钮：当此开关按钮打开时，内部预设效果处理器将静音，其输出不会出现在主混音或监听混音中。按钮指示灯将亮起，提示您效果已静音。
- 24 LEVEL 预设电平旋钮：调节内部预设效果输入声的音量。

应用效果器

MiXX8.6 带有高品质的内部信号处理效果器，在技术水平上与我们著名的 Podcast+ 效果器同样先进。应用效果器（如下所述）允许您模拟不同演奏环境的音效。

- 1. 转动 PRESETS 旋钮，从效果程序列表选择所需效果程序编号。
当前选定效果程序编号在显示屏中闪烁。
注：有关效果程序的详情，请参考下一页的“效果程序”列表。
- 2. 按下 PRESETS 旋钮以实际选择。
选定所需效果程序。
- 3. 按下 MUTE 静音开关按钮（红色亮起），应用效果将静音。
- 4. 转动 LEVEL 旋钮以调节应用效果的音量。

效果程序

编号	程 序	参 数	说 明
1	BRIGHT HALL	DECAY TIME	模拟音乐厅等明亮的大空间。
2	WARM HALL	DECAY TIME	模拟音乐厅等温和的大空间。
3	BRIGHT ROOM	DECAY TIME	模拟小型空间 (房间) 声学环境的明亮。
4	WARM ROOM	DECAY TIME	模拟小型空间 (房间) 声学环境的温和。
5	PLATE	DECAY TIME	模拟金属效果单元，产生棱角更加鲜明的效果。
6	DELAY (2S)	DECAY TIME	添加多个延迟2秒信号的反馈延迟。
7	DELAY STEREO	DECAY TIME	添加多个立体声延迟信号的反馈延迟。
8	DELAY PP	DECAY TIME	添加多个乒乓效果延迟信号的反馈延迟。
9	ECHO 1	DECAY TIME	用不同的普通回声。
10	ECHO 2	DECAY TIME	
11	ECHO 3	DECAY TIME	
12	CHORUS	SPEED	延迟时间添加多层声音，从而创建一种厚重的重奏感声音。
13	FLANGER	SPEED	为声音添加调试声，产生一种类似于喷气机引擎的起伏声。
14	HALL+DELAY	DECAY TIME	添加多个大空间延迟信号的反馈延迟。
15	HALL+CHORUS	SPEED	为大空间添加多层声音，从而创建一种厚重的重奏感声音。
16	DELAY+CHORUS	SPEED	延迟时间添加多层声音，从而创建一种厚重的重奏感声音。

MIXX8.6 (调音台) 后面板

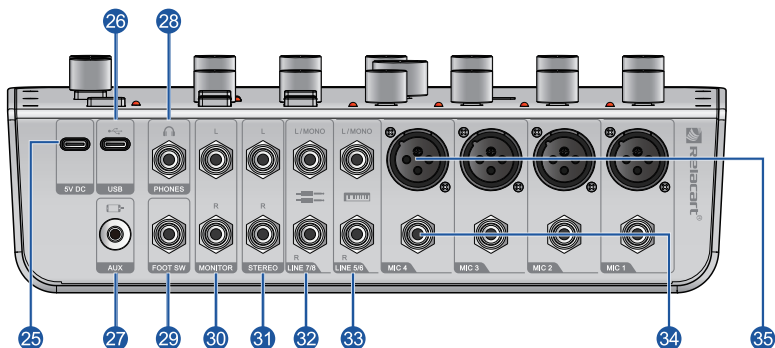

- 25 5V DC 端口：用于连接市场有售的 USB 电源适配器或 USB 移动电源。将调音台连接到平板电脑或其它无法为调音台供电的设备时，可以使用此端口。

须知

- 使用本产品前，请务必阅读您所使用的 USB 电源适配器或 USB 移动电源的安全注意事项。
- 请使用输出电压为 4.8 V–5.2 V 以及输出电流至少为 1A 或更高的 USB 移动电源或 USB 电源适配器。

- 26 USB 端口：用附带的 USB-C 连接线可连接到计算机。当连接到计算机时，计算机会为调音台供电，音频数据也可在调音台和计算机之间传输。

须知

请不要在 USB 端口上连接 PC、平板电脑或智能手机以外的设备。

- 27 AUX 输入插口：这是辅助输入插口，支持立体声 mini 插头。可以连接智能手机或其它设备，然后使用应用程序触发音效或背景音乐。用已连接的外接音频设备控制器调节音量。

- 28 PHONES 输出插口：用于连接耳机，此插口支持立体声 phone 型插头。

- 29 FOOT SW 插口：支持 phone 型插头，用于连接踏板开关。当应用 EFFECT 预设效果时，可将 EFFECT 静音。

- 30 MONITOR 输出插口：支持 phone 型插头（非平衡），用于连接有源监听音箱。

- 31 STEREO 输出插口：支持 phone 型插头，用于连接其他调音台或录音机，以立体声输出混合的声音。从这些插口输出的声音不会受到 STREAMING OUT 的 [OUTPUT] 开关按钮 14 或音箱 [] 旋钮 17 的影响。

- 32 LINE 7/8 输入插口：支持 phone 型插头，用于连接线路信号设备，如音频设备等。用通道 7/8 上的“L/MONO”插口连接单声道输出的乐器等。在这种情况下，输入到“L/MONO”插口的声音会从调音台的左右两个通道同时输出。

- 33 LINE 5/6 输入插口：支持 phone 型插头，用于连接线路信号设备，如电子键盘等。用通道 5/6 上的“L/MONO”插口连接单声道输出的乐器等。在这种情况下，输入到“L/MONO”插口的声音会从调音台的左右两个通道同时输出。

- 34 MIC 1/4 插口：这些 1/4”插口与麦克风前置放大器共享电路（不支持幻象供电），并且可以由任何电平的平衡或不平衡源驱动。你可以将这些输入来处理你遇到的任何信号。

- 35 MIC XLR 插口：这是一个 XLR 母连接器（支持幻象供电），可接受任何类型源的平衡麦克风或线路电平输入。这些专业的动圈和电容麦克风前置放大器具有更高的保真度和净空，可与当今市场上任何独立的麦克风前置放大器相媲美。这些电路在排除嗡嗡声和噪音方面很出色。

快速入门指南

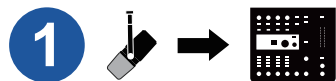

连接您的麦克风

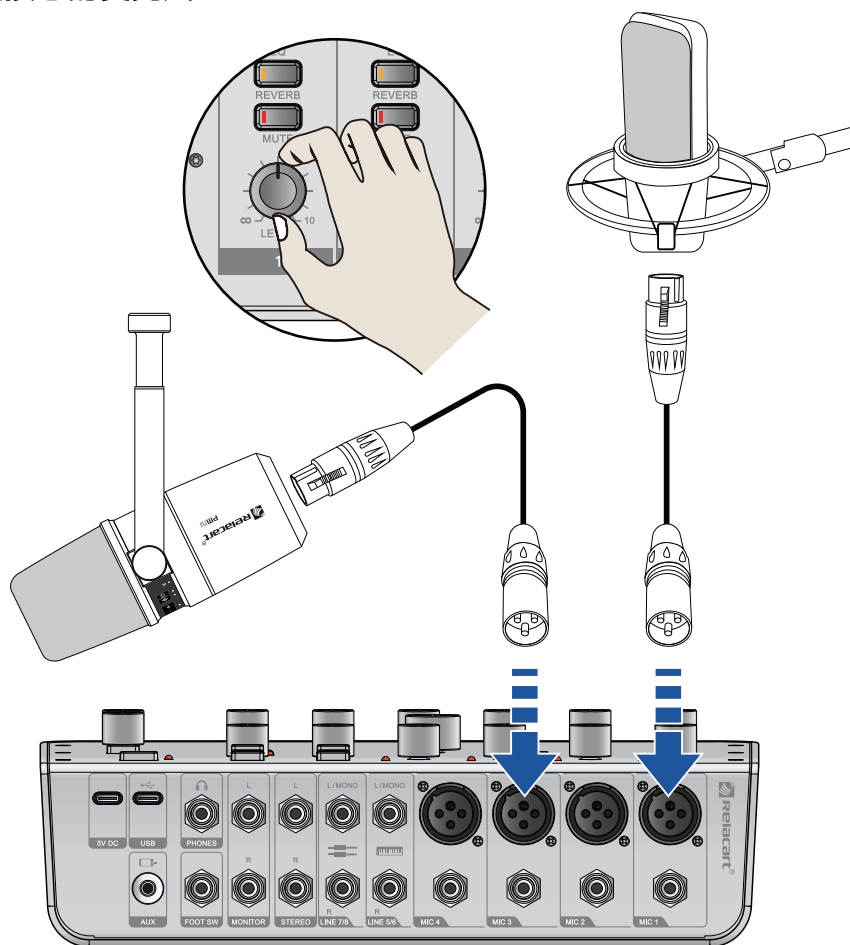

连接您的乐器

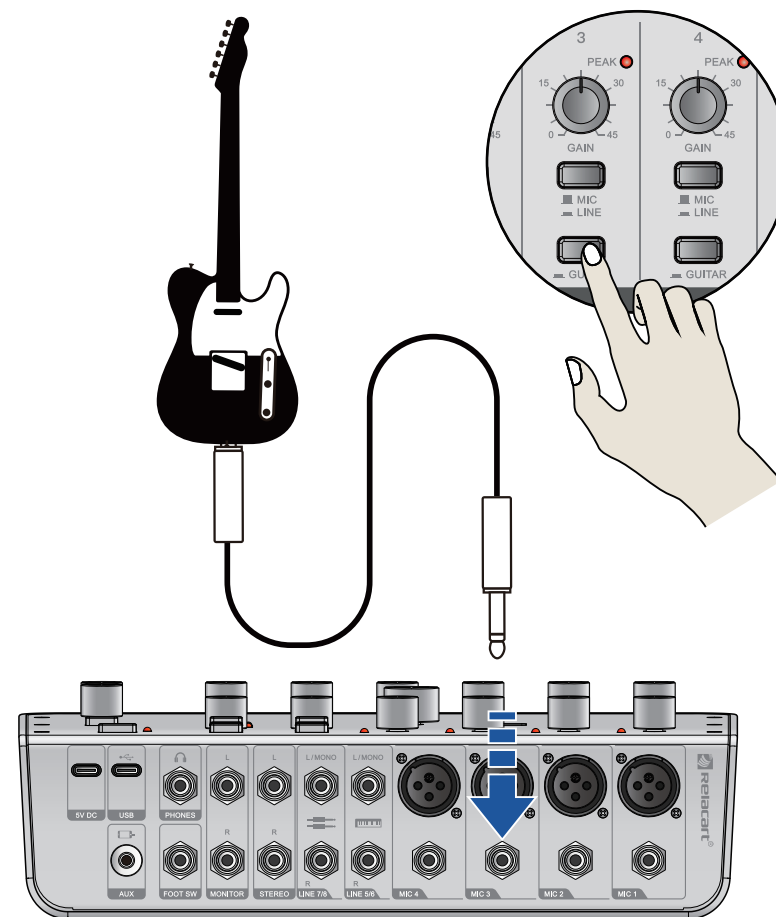



连接您的电子键盘设备

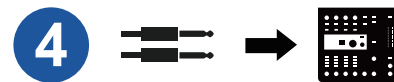
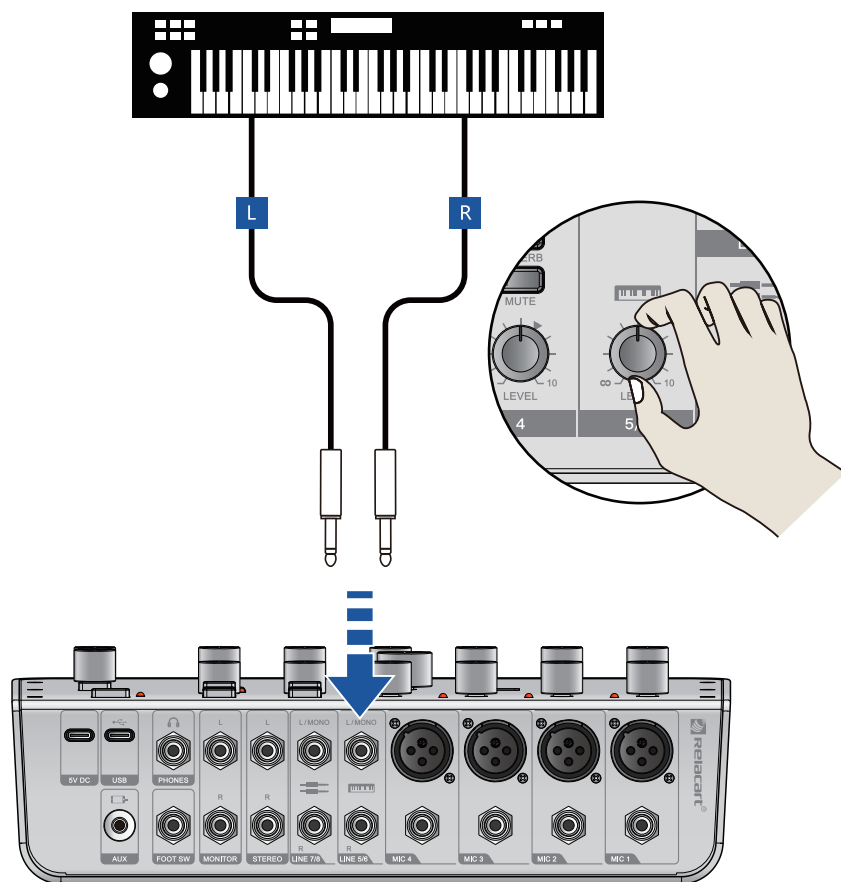

连接您的线路输入设备

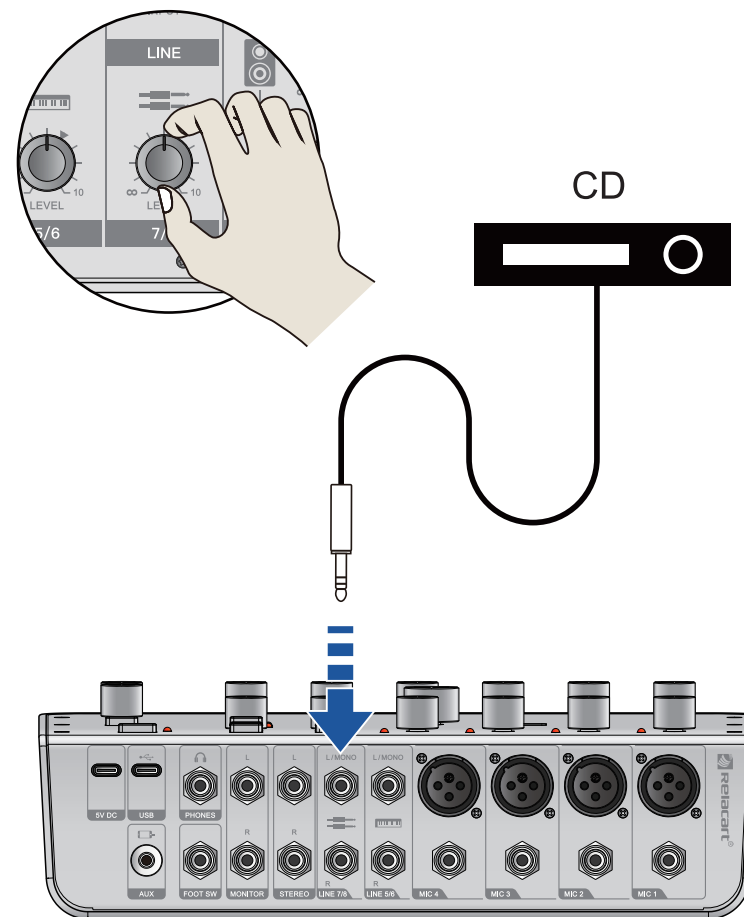



连接您的有源音箱

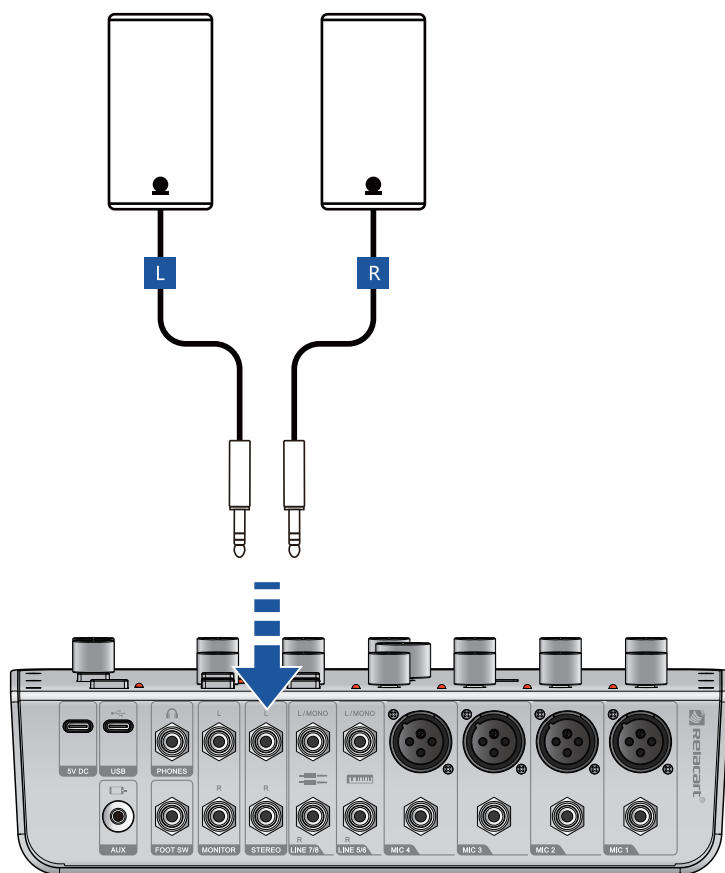

连接您的有源监听音箱

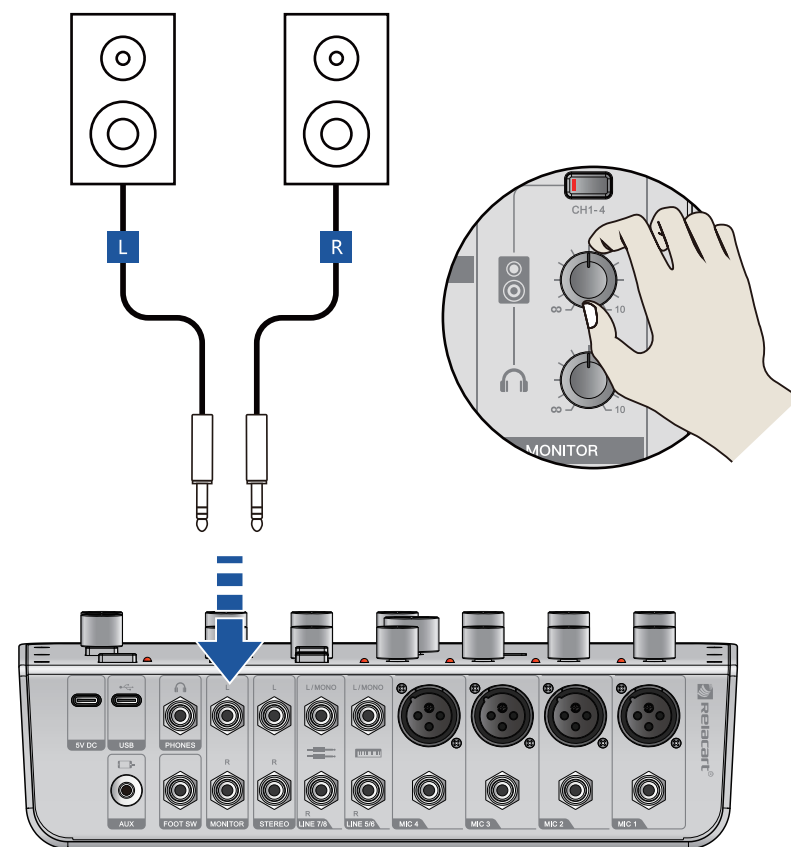



连接您的头戴式耳机

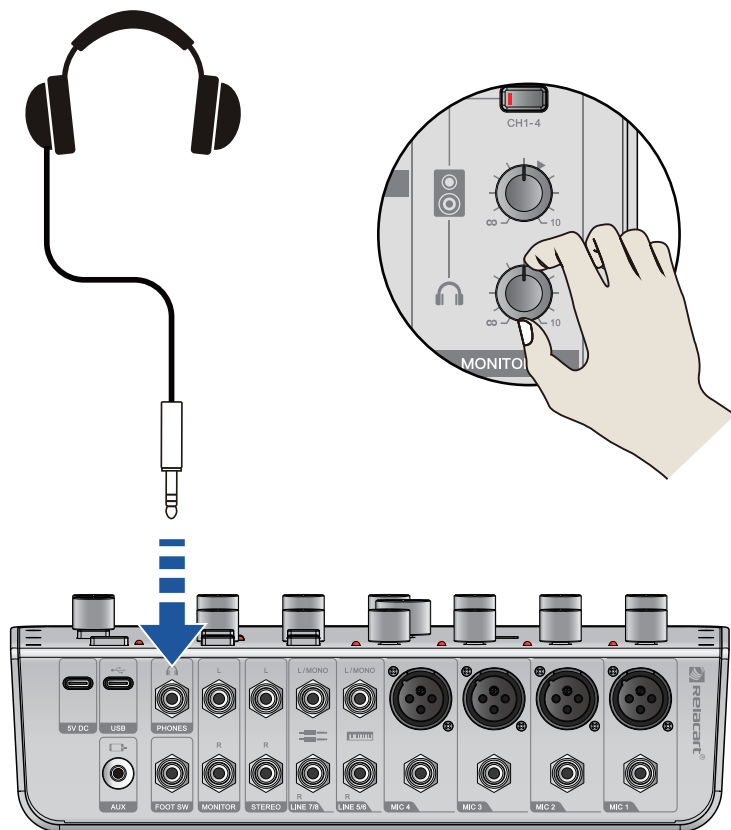

连接您的踏板开关

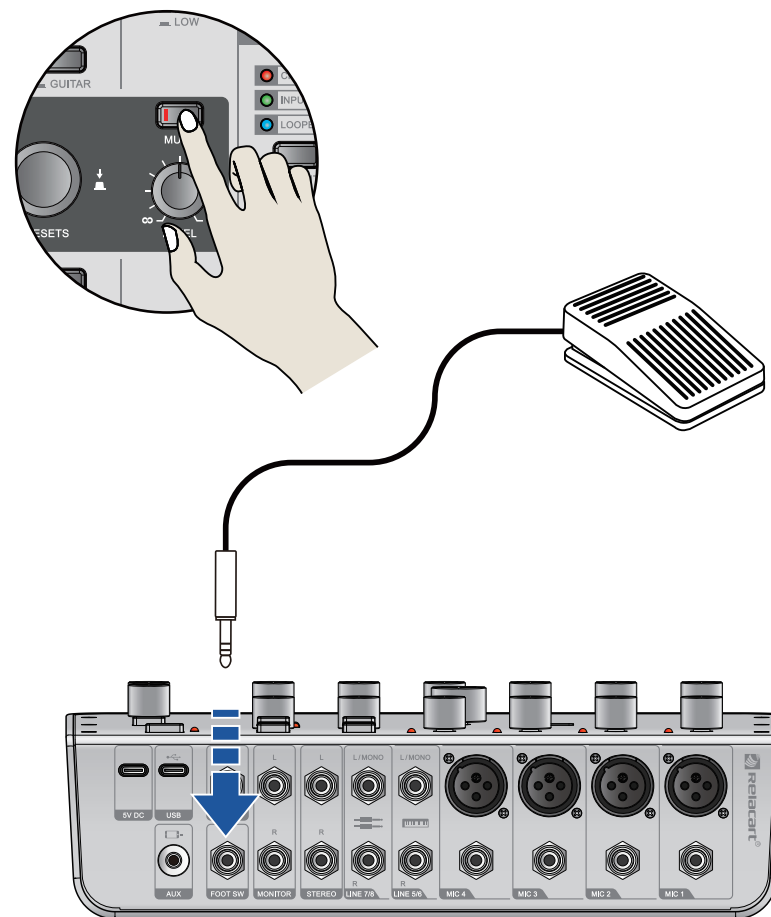



通过音频线连接您的手机

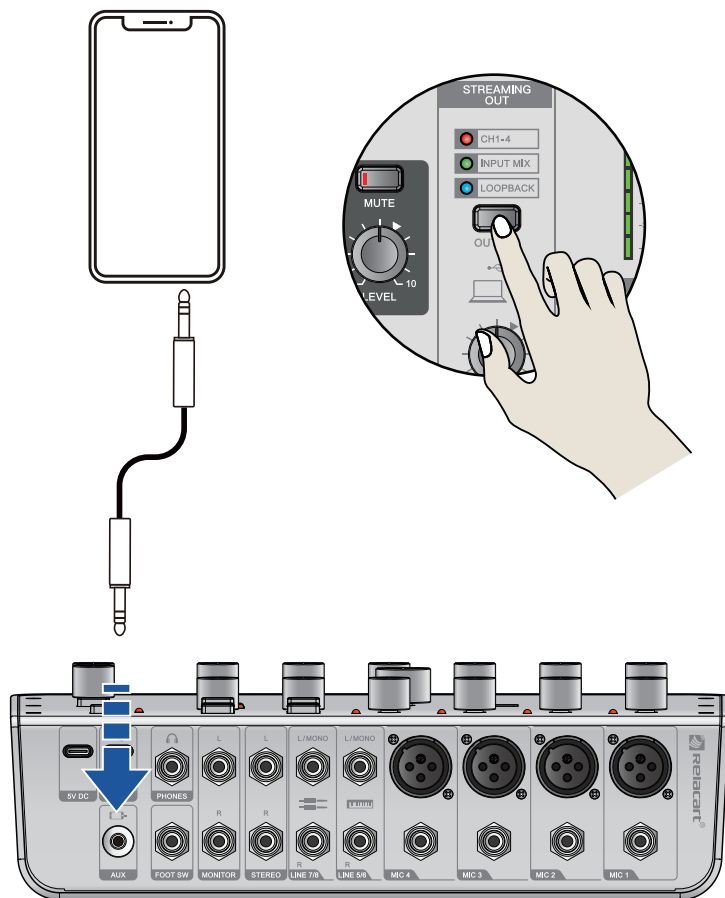

通过数据线连接您的电脑或智能手机

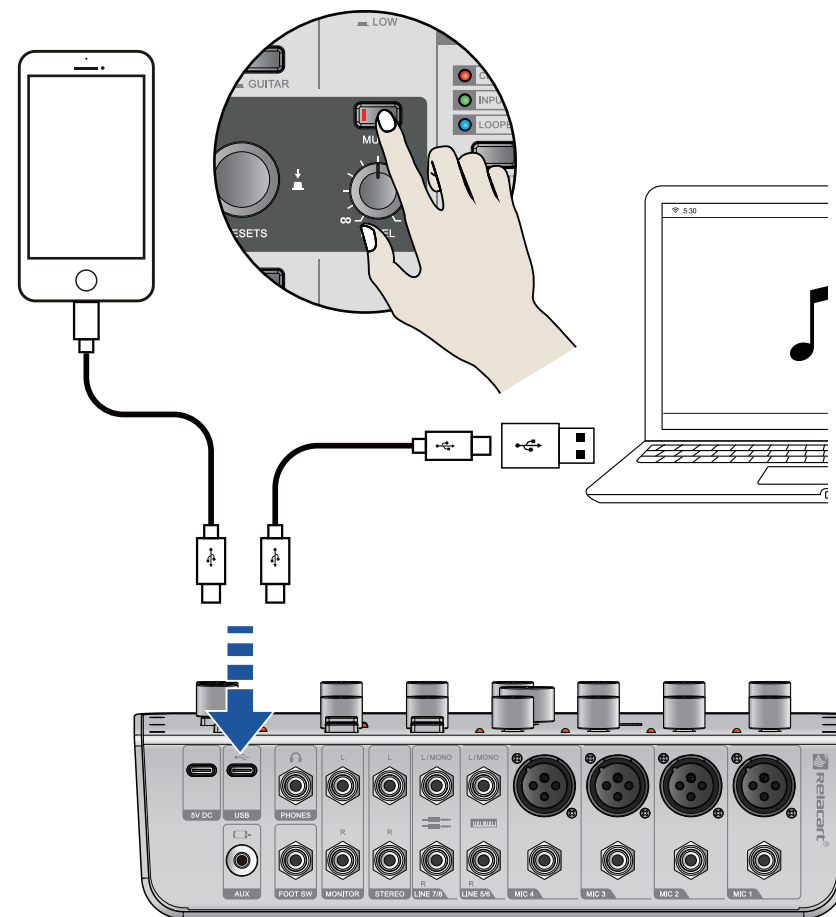

快速指南

1 连接音箱、话筒和乐器等

1. 关闭所有音箱、乐器和其它已连接到调音台的外接设备的电源。
2. 参考连接实例连接音箱、话筒和乐器。

2 音箱或耳机放出声音

1. 确保没有按下包括 POWER 电源开关在内的所有开关按钮。
2. 使用产品附带的 USB 连接线将调音台连接到计算机。
当使用调音台后面板的 USB 插口时，请参考“使用 USB 和 5V DC 插口的注意事项”。
连接平板电脑或其它无法为调音台供电的设备时，请将市场销售的 USB 电源适配器或 USB 移动电源连接到 5V DC 插口 (USB-C)。
3. 将 GAIN 旋钮、LEVEL 旋钮、音箱 [] 旋钮和耳机 [] 旋钮完全调节到左侧 (最小)。

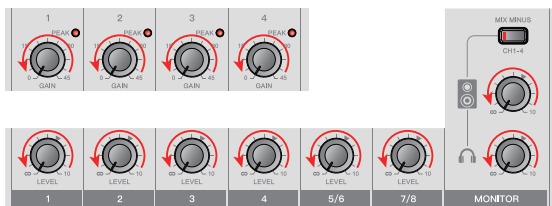

4. 确保有源音箱的音量设置到最小。
5. 按照下列顺序打开已连接设备的电源：乐器—音频设备—调音台电源—有源监听音箱。
须知：按照此顺序操作，可以避免音箱产生巨大的意外噪音。关闭电源时颠倒该顺序即可。
6. 对于连接了话筒或乐器的通道，可以将 GAIN 旋钮设置到大约 12 点钟位置。

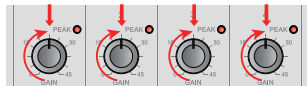

7. 将 LEVEL 电平旋钮调节到 3 点钟位置。



8. 将音箱 [] 旋钮和耳机 [] 旋钮调节到 12 点钟位置。

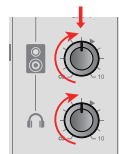

9. 对着话筒试音、演奏乐器或播放一下外接音频设备，然后调节有源音箱的音量。
10. 如果听不到声音或要调节音量，请按照下面方框中的介绍内容执行。

没有声音，或需要提高音量

1. 对着话筒说话或演奏一下乐器，向右调节 GAIN 旋钮让对应的 PEAK LED 灯短暂闪烁。
注：• 使用话筒时为获得最佳音量，请将话筒尽可能靠近声源。
• 如果 GAIN 旋钮已经完全调节到最右侧后，PEAK LED 灯依旧不能亮起，可以提高声源（乐器等）的音量。

如果步骤1执行之后，还是没有声音或音量无法增加：

2. 如果 [MIC/LINE] 开关按钮或 [HIGH/LOW] 开关按钮已经打开 ()，请将 LEVEL 电平旋钮完全调节到“∞” (最小)，然后关闭 () 此开关按钮。
3. 慢慢向右转动 LEVEL 电平旋钮，直到达到需要的音量。

要降低音量

1. 将 LEVEL 电平旋钮完全调节到“∞” (最小)，然后打开 () 要降低其音量的通道上的 [MIC/LINE] 开关按钮或 [HIGH/LOW] 开关按钮。
2. 慢慢向右转动 LEVEL 电平旋钮，直到达到需要的音量。
上述步骤执行后如果还是不能降低音量：
3. 降低外接设备或音频设备的音量。

控制软件使用说明

当 MI.AUDIO 软件下载安装完成, 请将 MIXX8.6 调音台连接至智能手机或电脑的 USB 接口, 并且打开 MI.AUDIO 软件, 选择 MIXX8.6 产品即可进入控制界面。



- ① 菜单
点击三个点区域访问应用设置、关于版本信息和用户指南。
- ② 设备选择
左右滑动选择产品设备。
- ③ 了解更多按钮
左右滑动 2 选择设备后, 按下此按钮进入产品了解。
- ④ 开始按钮
按下此按钮进入产品设置界面。如已连接设备则自动读取设备设置; 如未连接设备则显示离线状态。

控制界面

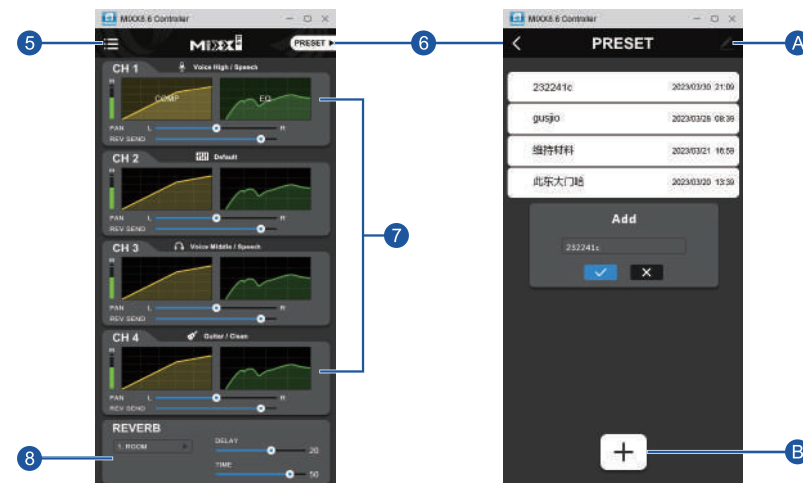

- ⑤ 菜单
点击可访问应用设置、关于版本信息和用户指南。
- ⑥ 调音台预设设置
按下此按钮进入产品预设界面, 可点击 **B** 添加或 **A** 删除设置好的参数保存到预设设置。最多可保存10个设置, 预设只保留在当前使用的设备。
- ⑦ 通道状态
显示4个通道的设置效果状态, 点击各通道的 COMP/EQ 图表, 可单独进入设置。还可自由调节左右声像和辅助发送的音量。
- ⑧ 混响设置
点击下拉菜单可选择一种模拟效果, 共设有12种效果。
混响是一种通过添加信号来模拟从大厅到小房间的表演空间的感觉, 从而产生声音的深度和宽度的效果。唱歌的演员经常被强化这种效果。
 - ◆ DELAY (延迟): 调节声音经过反射后, 回到人耳所需的时间, 可调节范围: 1~100。
 - ◆ TIME (时间): 调节混响效果持续的时间, 可调节范围: 1~100。

压缩器设置

压缩器是一种随着输入信号电平增大而本身增益减少的放大器。

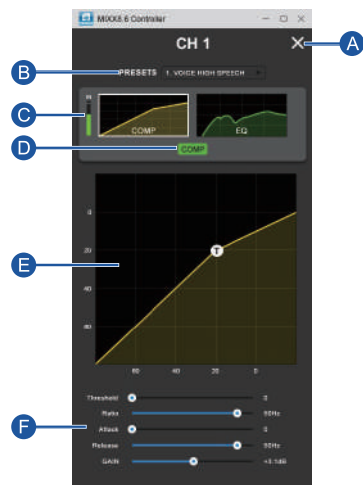

- A** COMP 界面关闭按键
调节 COMP 参数后点击可关闭 COMP 界面。(不需要另外保存参数, 每操作一个步骤, 调音台自动保存参数。)
- B** 预设选择
点击下拉菜单可选择默认预设设置。
- C** 电平指示
显示当前通道输入的电平值。
- D** COMP 按钮
灰色表示关闭 COMP 效果; 绿色表示打开 COMP 效果。
- E** COMP 调节窗口
可以在 COMP 功能窗口内任意拖动 COMP 频点, 以达到合适的效果。
- F** COMP 设置
对应 COMP 调节窗口的阈值, 也可以拖动推子微调阈值的参数。
 - ◆ Threshold (阈值): 调节压缩器的阈值 (及临界电平), 可调节范围: 0dB~60dB。
 - ◆ Ratio (比率): 压缩比1:250, 压缩比越大, 压缩幅度越小; 压缩比越小, 压缩幅度越大。
 - ◆ Attack (启动): 输入信号大于阈值后, 压缩器打开所需的时间, 可调节范围: 1ms~128ms。
 - ◆ Release (恢复): 输入信号小于阈值后, 压缩器关闭所需的时间, 可调节范围: 100ms~4000ms。
 - ◆ GAIN (增益): 调节压缩器的电平增益, 可调节范围: 0dB~-120dB。

均衡器设置

均衡器是通过增强和衰减特定频率来调整音调的效果。

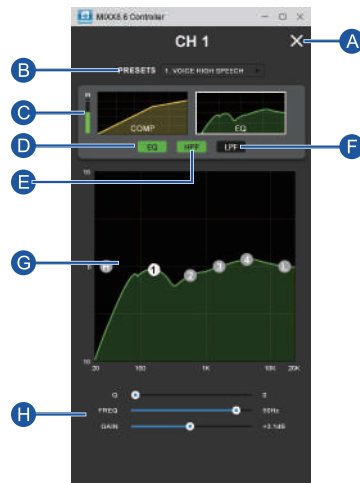

- A** EQ 界面关闭按键
调节 EQ 参数后点击可关闭 EQ 界面。(不需要另外保存参数, 每操作一个步骤, 调音台自动保存参数。)
- B** 预设选择
点击下拉菜单可选择默认预设设置。
- C** 电平指示
显示当前调音台输入的电平值。
- D** EQ 按钮
灰色表示关闭 EQ 效果; 绿色表示打开 EQ 效果。
- E** HPF 按钮
灰色表示关闭 HPF 效果; 绿色表示打开 HPF 效果。用于切断不需要的低声音, 并用于切割等应用。
- F** LPF 按钮
灰色表示关闭 LPF 效果; 绿色表示打开 LPF 效果。用于切断不必要的高声音, 并用于切割等应用。
- G** EQ 调节窗口
可以在 EQ 功能窗口内任意拖动 EQ 频点, 以达到合适的效果。共有4个频点可设置。
- H** EQ 频点设置
对应 EQ 调节窗口的频段球, 也可以拖动推子微调频段球的参数。
 - ◆ Q (Q值): 调节音频曲线的斜率, 可调节范围: 0.1~20。
 - ◆ FREQ (频率): 可调节范围: 20Hz~20KHz。
 - ◆ GAIN (增益): 调节均衡器的电平增益, 可调节范围: +18dB~-18dB。

技术指标

采样率:	24-bit, 48KHz
频率响应:	20Hz 至 20KHz +0/-1dB
总谐波失真:	<0.1%
信噪比:	90dB 单通道-推子最大 (A加权)
动态范围:	100dB 单通道-推子最大 (A加权)
共模抑制比:	>70dB @ 1KHz
MIC 输入阻抗:	3.3K Ω (XLR 平衡) ; 1.8K Ω (1/4")
LINE 输入阻抗:	10K Ω (1/4")
输出阻抗:	150 Ω
增益:	0 至 45dB (XLR)
FOOT SW :	REVERB ON/OFF
幻象电源:	+48V
USB音频:	2 IN/2 OUT 符合USB音频类2.0
电源:	DC 5V (1A)
耗电量:	最高 5W
尺寸 (mm) :	260 (L) x 230 (H) x 89 (D)
重量:	\approx 1.45 Kg

注意事项

请在操作使用前, 首先仔细阅读下述内容
请将本说明书存放在安全的地方, 以便将来随时参阅。

 警告

为了避免因触电、短路、损伤、火灾或其它危险可能导致的严重受伤甚至死亡, 请务必遵守下列基本注意事项。这些注意事项包括但不限于下列情况:

电源/电源线

- 只能使用本设备所规定的额定电压。所要求的电压被印在本设备的铭牌上。
- 只能使用提供的电源线。
- 请勿将电源线放置在热源如加热器或散热器附近, 不要过分弯折或损伤电源线, 不要在其上加压重物, 不要将其放置在可能被踩踏引起绊倒或可能被碾压的地方。
- 请务必连接到带有保护接地连接的适当电源插座。接地不当可能引起触电。

请勿打开

- 请勿打开本设备或试图拆卸其内部零件或进行任何方式的改造。本设备不含任何用户可自行修理的零件, 若出现异常, 请立即停止使用。

关于潮湿的警告

- 请勿让本设备淋雨或在水附近及潮湿环境中使用, 或将盛有液体的容器放在其上 (如花瓶、瓶子或玻璃杯), 否则可能会导致液体溅入任何开口。
- 切勿用湿手插拔电源线插头。

意识到任何异常情况时

- 若电源线出现磨损或损坏, 使用设备过程中声音突然中断或因此而发生异常气味或冒烟, 请立即关闭电源开关。
- 若本设备发生摔落或损坏, 请立即关闭电源开关, 从电源插座中拔出电源线插头。



小心

为了避免您或周围他人可能发生的人身伤害、设备或财产损失，请务必遵守下列基本注意事项。这些注意事项包括但不限于下列情况：

电源/电源线

- 当准备长期不使用本设备或发生雷电时，请从电源插座中拔出电源线插头。
- 当从本设备或电源插座中拔出电源线插头时，请务必抓住插头而不是电源线。直接拽拉电源线可能会导致损坏。

放置位置

- 移动设备之前，请务必拔出所有已连接的连接电缆。
- 设置设备时，请确认要使用的交流电源插座伸手可及。如果发生问题或故障，请立即断开电源开关并从电源插座中拔下插头。
- 若将本设备安装在 EIA 标准托架中，请使托架背面保持打开，并保证设备距离与墙壁或表面至少 10cm。另外，若将本设备与功率放大器等一般会产生热量的设备一起安装，请务必使本设备与产生热量的设备之间有足够的空间，或者安装通风面板放置本设备内部达到高温。
- 通风不畅可能导致过热，并可能损坏设备，甚至引起火灾。
- 请勿将任何均衡器和衰减器设定在最大位置。否则，根据所连接设备的具体状态，可能会导致反馈而损坏音箱。
- 为了避免操作面板发生变形或损坏内部组件，请勿将本设备放在有大量灰尘、震动、极端寒冷或炎热（如阳光直射、靠近加热器或烈日下的汽车内）的环境中。
- 请勿将本设备放在不稳定的地方，否则可能会导致突然翻倒。
- 请勿堵塞通风孔。本设备在正面和背面都有通风孔，用以防止设备内部温度过高。特别要注意不要侧面或上下颠倒放置本设备。通风不畅可能会导致过热，并可能损坏设备设置引起火灾。

连接

- 将本设备连接到其它设备之前，请关闭所有设备的电源开关。在打开或关闭所有设备的电源开关之前，请将所有音量都调到最小。
- 将音箱连接到音箱插口时，请使用音箱电缆。使用其它种类的电缆可能会导致火灾。

小心操作

- 请勿在电视、收音机、立体声设备、手机或其他电子设备附近使用本设备。这可能会在设备本身以及靠近设备的电视机或收音机中引起噪音。
- 打开音频系统的交流电源时，请始终最先打开本设备，以避免损坏音箱。同样，关闭电源时，请始终最后关闭本设备。
- 请勿将手指或手插入本设备的任何间隙或开口（通风口等）。
- 请避免在设备上的任何间隙或开口（通风口等）插入或落进异物（纸张、塑料、金属等）。如果发生这种情况，请立即关闭电源开关，然后从 DC/AC 电源插座中拔出电源插头。
- 请勿长时间持续在很高或不舒服的音量水平使用本设备或耳机，否则可能会造成永久性听力损害。如果遇到失聪或耳鸣的情况，请寻求医治。
- 请勿将身体压在本设备上或在其上放置重物，操作按钮、开关或插口时要避免过分用力。
- 清洁设备时，使用柔软的干布。请勿使用涂料稀释剂、溶剂、清洁液或浸了化学物质的抹布。